

EXAMINATION OF THE HUNTINGDONSHIRE LOCAL PLAN

HEARING STATEMENT

MATTER 12 – THE SUPPLY & DELIVERY OF HOUSING LAND

**FURTHER SUBMISSIONS ON BEHALF OF
GLADMAN DEVELOPMENTS IN RESPONSE TO EXAM/41 & EXAM/42**

RESPONDENT ID NUMBER: 1118265

4 OCTOBER 2018

CONTENTS

PAGE NUMBER

| | | |
|----|--|---|
| 1. | INTRODUCTION | 1 |
| 2. | EXAM/41 - ADDITIONAL SOURCES OF SUPPLY | 2 |
| 3. | EXAM/42 – ALCONBURY WEALD | 4 |

APPENDICIES

Appendix 1 Officer's Report Relating To Land At Bluntisham Road, Needingworth (LPA Reference: 17/01687/OUT)

Hourigan Connolly
7 Swan Square
15 Swan Street
Manchester
M4 5JJ

t/ 0161 300 3476
e/ info@houriganconnolly.com
w/ www.houriganconnolly.com

1. INTRODUCTION

1.1 This document is submitted on behalf of Gladman Developments Limited (hereafter referred to as Gladman) and responds to EXAM/41 dated 28 September 2018 and received by us on 1 October 2018. This document also responds to EXAM/42 dated 28 September 2018 and received by us on 1 October 2018.

1.2 We have no observations on:

- EXAM/39 – Completions & Commitments.
- EXAM/40 - Live Table 253a.

2. EXAM/41 - ADDITIONAL SOURCES OF SUPPLY

WINDFALLS ON SITES OF 10+ DWELLINGS

BLUNTISHAM ROAD, NEEDINGWORTH

- 2.1 On 28 May 2018 the Council's Development Control Committee approved an outline planning application for 120 dwellings subject to conditions and completion of a Section 106 Agreement (LPA Reference: 17/01687/OUT). A copy of the Officer's report appears at **Appendix 1**. It is fairly clear from the assessment section of the report (Paragraph 7.12 onwards) and the planning balance section of the report (Paragraph 7.172 onwards) that this is a scheme that was contrary to Development Plan policy and was recommended for approval on the basis that the tilted balance test of the Framework was in play.
- 2.2 If the Council is correct in its submissions to the Local Plan Examination and there would be a 5 year supply of deliverable dwellings upon adoption of the Local Plan then sites such as Bluntisham Road would not benefit from the tilted balance test and hence are unlikely to come forward in the future. Whilst the Bluntisham Road site may well comprise evidence of a previous windfall that the Council has approved it does nothing to assist the Examination in terms of future rates of windfalls. As mentioned at the Examination Paragraph 48 of the Framework concerns windfalls but it requires **compelling** evidence that such sites have come forward in the past **and** will continue to do so in the future; hence it is a two-part test. Accordingly, the Council is right not to make an allowance for windfalls on sites of 10+ dwellings going forward.

WINDFALLS ON SITES OF LESS THAN 10 DWELLINGS

- 2.3 Similar sentiments apply to small windfall sites as large windfall sites. Whilst there is no dispute that some small site windfall sites will continue to come forward in the future there simply isn't the compelling evidence before the Examination as required by Paragraph 48 of the Framework to justify including an allowance reflective of past levels of delivery.

PRIOR APPROVALS

- 2.4 The prior approval regime for conversion of existing buildings to residential is a relatively recent concept and hence it is unsurprising that in recent years rates have been buoyant. However, this is a finite source of supply and as evidenced in our Hearing Statement there is evidence that prior approvals for conversion of offices to residential do not always result in the completion of new dwellings. Indeed, taking just the one example in our Hearing Statement points to a 3% lapse rate being inadequate and a 10% lapse rate on commitments being more reasonable.

- 2.5 Moreover, there is simply no evidence before the Examination that previous rates of completions via the Prior Approval route will continue into the future. The Council acknowledge as much by noting that predicting future completions based on a limited time series has limited reliability.
- 2.6 Prior approvals are effectively windfalls and applying the tests in Paragraph 48 of the Framework we are firmly of the view that the compelling evidence required to include an allowance from this source of supply going forward is conspicuous by its absence.

RURAL EXCEPTIONS

- 2.7 Again, the Council's optimism that 45 dwellings per annum will materialise from rural exception sites is not backed by the compelling evidence necessary to include this type of windfall in the housing trajectory. No allowance should be made in the housing trajectory for this source of supply.

3. EXAM/42 – ALCONBURY WEALD

- 3.1 The email from Andrew Fisher of David Lock Associates is noted however whilst there are 259 dwellings under construction on the site at this time that does not mean to say that 259 dwellings will be completed on the site during this monitoring year. EXAM/26 notes a revised anticipated delivery of 207 dwellings for the current monitoring year.

Appendix 1

Case No: 17/01687/OUT (OUTLINE APPLICATION)

Proposal: OUTLINE PLANNING APPLICATION FOR THE DEMOLITION OF THE BUNGALOW, SIX POULTRY SHEDS AND OTHER OUTBUILDINGS AND THE ERECTION OF UP TO 120 DWELLINGS WITH PUBLIC OPEN SPACE, LANDSCAPING AND SUSTAINABLE DRAINAGE SYSTEM (SUDS) AND A VEHICULAR ACCESS POINT FROM BLUNTISHAM ROAD. ALL MATTERS RESERVED EXCEPT FOR MEANS OF ACCESS.

Location: LAND SOUTH OF THE A1123 AND WEST OF BLUNTISHAM ROAD NEEDINGWORTH

Applicant: GLADMAN DEVELOPMENTS

Grid Ref: 534695 272719

Date of Registration: 10.08.2017

Parish: HOLYWELL-CUM-NEEDINGWORTH

RECOMMENDATION - APPROVE

This application is referred to the Development Management Committee in accordance with the Scheme of Delegation as it is a Departure from the Development Plan, and Needingworth Parish Council's recommendation of refusal is contrary to the Officer recommendation of approval.

1. DESCRIPTION OF SITE AND APPLICATION

1.1 This application relates to 6.44 hectares of land situated to the north of the settlement of Needingworth. The land forming the application site is within various uses. The northern third of the application site comprises a poultry farm with poultry sheds, associated outbuildings and a bungalow, occupied by the manager of the poultry farm. To the south of this, the land forming the central third of the application site is used for the grazing of animals whilst the southern third of the site comprises a small holding and a disused orchard.

The site

1.2 None of the site is publicly accessible. There are no footpaths or other rights of way within or bounding the site. However, a public footpath is located to the north-east of the site, extending from the eastern side of Bluntisham Road and connecting to the A1123. In addition, there is a bridleway leading east from Bluntisham Road which gives pedestrian access to the new Ouse Fen RSPB reserve; situated to the south-east of the application site, to the opposite side of Bluntisham Road.

- 1.3 To the north of the application site is an agricultural field, beyond which is the A1123. As a result of the road alignment, the A1123 also runs immediately adjacent to the north-western boundary of the application site. To the west of the site are agricultural fields; whilst to the east of the site, on the opposite side of Bluntisham Road are several residential properties. With the exception of these dwellings, the land to the east of the application site is predominantly within agricultural use. To the south of the application site are two residential dwellings, currently separated by an agricultural field. This agricultural field benefits from planning permission for the erection of 14 dwellings as a rural exception site (ref: 17/01077/FUL).
- 1.4 The site is broadly level with no significant undulations and has hedgerows extending along the southern, eastern and western site boundaries. Three distinct lines of hedgerow run from east to west across the width of the site, with further sections of hedging also situated within the site.
- 1.5 Vehicular access is proposed from Bluntisham Road, adopting a broadly similar location to the existing access point into the poultry farm and associated dwellinghouse. Pedestrian access points along the eastern site boundary to Bluntisham Road are also proposed.
- 1.6 This application is in outline with 'access' the only matter to be considered in detail at this stage. The final layout, scale, appearance and landscaping are 'Reserved Matters' to be considered at a future date (should outline permission be granted). The application is accompanied by a 'Development Framework Plan' and an 'Illustrative Masterplan' (included within the Design and Access Statement) showing how the application site could be developed and demonstrating that the site is capable of accommodating the scale of development proposed (up to 120 dwellings). However, the illustrative layout shown on these plans is not necessarily the way the development will be carried out; as this would be established at reserved matters stage.
- 1.7 The planning application is supported by the following reports:
- * Air Quality Screening Assessment
 - * Design and Access Statement
 - * Ecological Impact Assessment (including Bat and Reptile Surveys)
 - * Flood Risk Assessment and Outline Surface Water Drainage Strategy
 - * Foul Drainage Analysis
 - * Heritage Desk Based Assessment
 - * Infiltration Test Results
 - * Landscape and Visual Impact Assessment
 - * Noise Assessment (including addendum)
 - * Planning Statement
 - * Preliminary Risk Assessment
 - * Statement of Community Involvement
 - * Sustainability Statement
 - * Transport Assessment (including addendum entitled Transport Note)
 - * Travel Plan
 - * Tree Survey
 - * Utilities Statement

2. NATIONAL GUIDANCE

- 2.1 The National Planning Policy Framework (NPPF) (2012) sets out the three dimensions to sustainable development - an economic role, a social role and an environmental role - and outlines the presumption in favour of sustainable development. Under the heading of Delivering Sustainable Development, the Framework sets out the Government's planning policies for : building a strong, competitive economy; ensuring the vitality of town centres; supporting a prosperous rural economy; promoting sustainable transport; supporting high quality communications infrastructure; delivering a wide choice of high quality homes; requiring good design; promoting healthy communities; protecting Green Belt land; meeting the challenge of climate change, flooding and coastal change; conserving and enhancing the natural environment; conserving and enhancing the historic environment; and facilitating the sustainable use of minerals.
- 2.2 Planning Practice Guidance

For full details visit the government website

<https://www.gov.uk/government/organisations/department-for-communities-and-local-government>

3. PLANNING POLICIES

- 3.1 Saved policies from the Huntingdonshire Local Plan (1995)
- H31: "Residential privacy and amenity standards"
 - H37: "Environmental Pollution"
 - H38: "Noise Pollution"
 - T18: "Access requirements for new development"
 - T19: "Pedestrian Routes and Footpath"
 - T20: "Cycle Routes"
 - T21: "Public transport services"
 - R1: "Recreation and Leisure Provision"
 - R2: "Recreation and Leisure Provision"
 - R3 "Recreation and Leisure Provision"
 - R7 "Land and Facilities"
 - R8 "Land and Facilities"
 - R12: "Land and Facilities"
 - En12: "Archaeological Implications"
 - En13: "Archaeological Implications"
 - En18: "Protection of countryside features"
 - En19: "Trees and Landscape"
 - En20: "Landscaping Scheme"
 - En22: "Conservation"
 - En23: "Conservation"
 - En24: "Access for the disabled"
 - En25: "General Design Criteria"
 - CS8: "Water"
 - CS9: "Flood water management"
- 3.2 Saved policies from the Huntingdonshire Local Plan Alterations (2002)
- HL5 - Quality and Density of Development
 - HL6 - Housing Density

- HL10 - Housing Provision
 - OB2 - Maintenance of Open Space
- 3.3 Huntingdonshire Local Development Framework Core Strategy (2009)
- CS1: "Sustainable development in Huntingdonshire"
 - CS2: "Strategic Housing Development"
 - CS4: "Affordable Housing in Development"
 - CS10: "Contributions to Infrastructure Requirements"
- 3.4 Huntingdonshire's Local Plan to 2036: Proposed Submission 2017 (as amended March 2018 for submission)
- LP 1: "Amount of development"
 - LP 2: "Strategy and principles for development"
 - LP 3: "Green Infrastructure"
 - LP 4: "Contributing to Infrastructure Delivery"
 - LP 5: "Flood Risk"
 - LP 6: "Waste Water Management"
 - LP 10: "Small Settlements"
 - LP 11: "The Countryside"
 - LP 12: "Design Context"
 - LP 13: "Design Implementation"
 - LP 14: "Placemaking"
 - LP 15: "Amenity"
 - LP 16: "Surface Water"
 - LP 17: "Sustainable Travel"
 - LP 18: "Parking Provision and Vehicle Movement"
 - LP 25: "Affordable Housing Provision"
 - LP 26: "Housing Mix"
 - LP 31: "Health Impact Assessment"
 - LP 32: "Biodiversity and Geodiversity"
 - LP 33: "Trees, Woodland, Hedges and Hedgerows"
 - LP 36: "Heritage Assets and their Settings"
 - LP 39: "Ground Contamination and Groundwater Pollution"
- 3.5 Policy Weighting
- Paragraph 215 of the NPPF advises that due weight should be given to Development Plan policies which pre-date the NPPF according to their degree of consistency with the Framework. Paragraph 216 of the NPPF advises that policies in emerging plans can be given weight from the day of publication according to:
- * the stage of preparation of the emerging plan (the more advanced the preparation, the greater the weight that may be given);
 - * the extent to which there are unresolved objections to relevant policies (the less significant the unresolved objections, the greater the weight that may be given); and
 - * the degree of consistency of the relevant policies in the emerging plan to the policies in this Framework (the closer the policies in the emerging plan to the policies in the Framework, the greater the weight that may be given).
- 3.6 The LPA consider the Local Plan to 2036 to be a sound plan and it was submitted for examination on the 29th March 2018. The plan has therefore reached an advanced stage and is consistent with the policies set out within the NPPF.

- 3.7 Housing Supply Policies - In order to satisfy the requirements of the NPPF to boost housing supply the Council must demonstrate an up-to-date five year supply of deliverable housing sites to meet its objectively assessed need, with an additional buffer to ensure choice and competition in the market for land; this requirement is set out in paragraph 47 of the NPPF. Due to under delivery in recent years the buffer to be applied for the District is 20%. The December 2017 Annual Monitoring Review applies the 20% buffer and demonstrates that the Council has a five year supply of housing land.
- 3.8 The Development Plan policies relevant to the supply of housing (En17 and H23 of the Huntingdonshire Local Plan (HLP) and CS2 and CS3 of the Huntingdonshire Core Strategy (HCS)) were set against a lower Objectively Assessed Need figure. Therefore strict application of these policies would result in failure to achieve the objectively assessed housing need figure that the Council currently has identified as part of the emerging Local Plan to 2036, and these policies taken in isolation could be considered not to be up-to-date.
- 3.9 These policies are therefore no longer fully up-to-date or consistent with the NPPF and, at this time and until the Council adopts the Local Plan to 2036 with up-to-date policies, the 'tilted balance' as set out within the 4th bullet point of para. 14 is engaged. For decision-taking this means granting permission in instances where the Development Plan is absent, silent or relevant policies are out-of-date unless any adverse impacts would significantly and demonstrably outweigh the benefits (having regard to the Framework policies taken as a whole), or specific policies of the Framework indicate development should be restricted.
- 3.10 Countryside Policies - Policies H23, En17 and CS3 have environmental objectives which are all firmly aimed at protecting the environment and landscape character. Core principles of the NPPF are to recognise the intrinsic character and beauty of the countryside and differing roles and character of the areas whilst supporting local communities in rural areas. The NPPF therefore has a slightly more positive approach to development in the countryside than the restrictive development plan policies, and this partial inconsistency requires a reduction in weight.
- 3.11 Whilst there is some difference in the wording between the policies written before the NPPF publication and the precise wording of the NPPF, the countryside policies are considered to accord with one of the overarching aims of the NPPF. As such, having regard to paragraph 215 of the NPPF it is considered that when assessing impacts of development upon the countryside these policies can be afforded significant (reduced from full) weight.
- 3.12 Sustainable Development - Policy CS1 of the adopted Core Strategy 2009 sets out the criteria for sustainable development and is broadly consistent with the NPPF. Having regard to the NPPF paragraph 215, this policy is considered to have full weight, given the NPPF requirement for development to be sustainable and jointly and simultaneously achieve economic, social and environmental gains.

- 3.13 Developer Contributions - Having regard to policies relating to contributions - Saved policy OB2 of the HLPAs advises that financial contributions for the maintenance of open space may be sought to benefit the development. This is consistent with the social dimension of the NPPF which requires developments to contribute to healthy communities and a high quality environment and NPPF para 73 specifically highlights the contribution that high quality open spaces can make to the health and well-being of communities. The degree of consistency between saved policy OB2 and the NPPF in this regard warrants giving policy OB2 significant weight.
- 3.14 Policy CS4 of the HCS seeks to secure a target of 40% affordable housing provision for residential development (of above 15 or more homes) subject to, amongst other considerations, viability. Chapter 6 of the NPPF 'Delivering a wide choice of high quality homes' notes that LPAs should significantly boost the supply of housing and refers to the need to provide market and affordable housing and states that policies should be set to meet the identified need for affordable housing. CS4 is based upon identified need and it is therefore considered that policy CS4 can be given significant weight. Policy LP 25 of the Local Plan to 2036 also seeks to secure affordable housing provision within developments. This policy targets 40% affordable housing and requires a mix of tenure splits and dispersal across sites, in line with Core Strategy policy CS4, it does however change the threshold for qualifying sites to 11 homes or more, or 1,001m² or more of residential floorspace. The policy acknowledges that the target provision may not always be viable due to specific site conditions or other material considerations. As such this policy can be afforded significant weight; whilst there is a difference between the threshold for affordable housing in the adopted and emerging policies, it is noted that this does not affect the consideration of major developments such as this application.
- 3.15 Policy CS10 of the HCS is the relevant policy for securing contributions to infrastructure requirements, including affordable housing, open space, transport, community facilities, education, health, and waste recycling facilities. This policy is consistent with the NPPF policies and paragraphs 203 and 204 which relate to planning obligations and therefore carries significant weight. This policy relates to the Developer Contributions SPD 2011, which sets out the standards and formulae for calculating developer contributions. Policy LP 4 of the Local Plan to 2036 relates to Infrastructure Delivery and relates to the Developer Contributions SPD 2011 which sets out the standards and formulae for calculating developer contributions. Policy LP 17 of the Local Plan to 2036 relates to sustainable travel and seeks to secure appropriate mitigation measures for likely transport impacts. These policies can be afforded significant weight also.
- 3.16 Supplementary Planning Guidance / Other relevant documents:
- Huntingdonshire Design Guide SPD (2017): Place Making Principles - Part 3.3 Walkable Places, Parts 3.5 Parking and Servicing, 3.7 Building Form.
 - Huntingdonshire Landscape and Townscape Assessment (2007)
 - Strategic Flood Risk Assessment for Huntingdonshire (2017)
 - Developer Contributions SPD (2011)

- RECAP CCC Waste Management Design Guide (CCC SPD) 2012

Local policies are viewable at <https://www.huntingdonshire.gov.uk>

4. PLANNING HISTORY

Application Site:

- 4.1 7800279FUL - Replace Boiler House With Building. Permission Granted, 03.04.1978.
- 4.2 8601421FUL - Redevelopment of existing poultry broiler site. Permission Granted, 20.10.1986.
- 4.3 8901921OUT - By-Pass proposal with residential development, open space and petrol filling stations, Land north of Needingworth. Withdrawn.
- 4.4 9001295CCC - Construction of By-Pass. Land to North West,(A1123) Needingworth. Permission Granted, 21.12.1990.
- 4.5 16/00745/P3MPA - Prior Approval for the proposed change of use from an agricultural building to a flexible use under Class R. Approved, 06.07.2016.

Land to the south of the application site:

- 4.6 17/01077/FUL - 14 New homes on land adjacent to Fair View, Bluntisham Road, Needingworth. Permission Granted, 16 February 2018.

5. CONSULTATIONS

- 5.1 **Needingworth Parish Council** - First Comments - recommend REFUSAL - due to concerns in relation to the principle of the development due to the location of the site outside of the built up area and local housing need being met through a rural exception site, the scale of development and inability of existing services to support a development of this scale (including the primary school and St Ivo Secondary School), loss of agricultural land, noise impacts, odour, intrusive light pollution arising from the development, highway safety and inadequacy of the existing footpaths to serve the development, the scale and appearance of the development and detrimental visual impacts arising from the drainage scheme. HDC can demonstrate a five year supply of housing land and its current policies are up to date, therefore there is no reason why the site should be given approval. The Parish Council has set out a list of improvements and recommendations which it considers should be included within a Section 106 Agreement if the application is recommended for approval (COPY ATTACHED).
- 5.2 **Needingworth Parish Council** - Following Re-consultation - recommend REFUSAL - The Parish Council have considered the amendments to the original plans and also the additional resident comments. Council consider that the amendments have not

addressed any of their original concerns and therefore the original comments objecting to the proposed development dated 20/9/17 still stand (COPY ATTACHED).

- 5.3 **Cambridgeshire Constabulary** - NO OBJECTION from a crime and disorder perspective. No crime prevention strategy at this stage but would wish to comment on reserved matter details and measures to mitigate crime and disorder.
- 5.4 **Cambridgeshire Fire and Rescue** - NO OBJECTION subject to securing provision for fire hydrants through Section 106 or a planning condition.
- 5.5 **Cambridgeshire County Council Archaeology** - NO OBJECTION subject to condition securing an archaeological evaluation as the site is located in a landscape of high archaeological potential.
- 5.6 **Cambridgeshire County Council Education** - There is a shortfall of early years places at Needingworth Community Pre-School. It is acknowledged that there is plentiful pre-school provision in St Ives. The primary school is close to full capacity (total capacity of 210 places. It had 202 pupils on roll in September 2017). However the school is forecast to have sufficient capacity in the future if out-catchment options are excluded. St Ivo Secondary school is close to full capacity (total capacity of 1500 places. It had 1423 pupils on roll in September 2017). There may be a need to expand the school in the long term, given the continuing growth in St Ives. However, there is no current project in the capital programme to do so and the catchment forecasts do not show a pressing need for this in the short to medium term. In conclusion, there will be a need to mitigate the impact from this development at early years level but not primary or secondary levels. It is noted that the development is under 200 dwellings and therefore S106 contributions cannot be sought.
- 5.7 **Cambridgeshire County Council as Lead Local Flood Authority (LLFA)** - NO OBJECTION - The applicant has demonstrated that surface water can be dealt with on site by using swales and an infiltration pond in a Sustainable Drainage System (SuDS) management train, restricting surface water discharge to QBAR at a rate of 13.1 l/s. The LLFA is supportive of the use of swales and an infiltration pond as in addition to controlling the rate of surface water leaving the site it also provides water quality treatment which is of particular importance when discharging into a watercourse. The topography of the site falls to the north, a SuDS management train of swales perpendicular to this gradient will capture surface water and control conveyance across the site in a cascade model. Surface water flood risk is medium or high in parts of the site, however SuDS features have been positioned in these locations to provide storage and controlled conveyance.
- 5.8 **Anglian Water** - Needingworth Water Recycling Centre will have available capacity for these flows. The sewerage system has available capacity for the anticipated flows. The proposed method of surface water drainage does not relate to Anglian Water operated assets. The LLFA/Internal Drainage Board (IDB)/Environment Agency (EA) should be consulted accordingly.

- 5.9 **Environment Agency** - no comment to make on this application.
- 5.10 **Cambridgeshire County Council as Local Highways Authority** - NO OBJECTIONS - subject to conditions/obligations in relation to:
- provision of a shared footway/cycleway on the eastern side of Bluntisham Road.
 - provision of a footway including bus hard standing and dropped kerb crossings on the western side of Bluntisham Road.
 - a new bus stop on the western side of Bluntisham Road, to include a new shelter, raised kerbs, real time passenger information and a maintenance contribution.
 - upgrading of the existing bus stop on the eastern side of Bluntisham Road, to include a new shelter, raised kerbs, real time passenger information and a maintenance contribution.
 - provision and implementation of a Residential Welcome Pack for sustainable transport, to include six months free bus travel with the relevant local public transport operator.
 - provision and implementation of a Residential Travel Plan.

In relation to access, the proposed access to the development is indicated as being 5.5m in width with 7.5m radii which is sufficient for the proposed number of dwellings. The vehicle to vehicle visibility splays (both vehicle to vehicle and pedestrian have been derived from the recorded traffic speeds in the location and are therefore acceptable. Offsite works, the connecting footways from the village to the development have been indicated and include a connection to the existing footway to the north of the site. The proposed offsite works have been put forward and a stage1 (in principle) safety audit has been carried and has found no issues. Therefore with regards to the access arrangements and the offsite works, no objections to the proposal subject to conditions relating to: maintenance and management arrangements for the roads and footpaths, the minimum width of the vehicular access being 5.5m for the first 50m into the site, the access being constructed with 7.5m radius kerbs, the provision of temporary facilities for the parking, turning and unloading of vehicles during construction, the provision of visibility splay as shown the plans submitted and the maintenance of these free obstruction, adequate drainage measures being incorporated to prevent surface water run-off to the adjacent public highway, construction of the road in accordance with CCC specification, details of the route for construction traffic being agreed and wheel washing facilities being provided on site.

- 5.11 **HDC Environmental Health** - NO OBJECTIONS - Subject to conditions regarding noise and contamination.
- 5.12 **HDC Housing** - NO OBJECTIONS - If the application is acceptable in broader planning policy terms, the affordable housing that would be provided would be welcomed. However the affordable housing should be secured by S106.
- 5.13 **HDC Operations Green Space** - NO OBJECTIONS - The layout is much better than the previous plan with the proposed children's play area more accessible to the rest of the development and a better road layout. The maintenance rates for the open space on site provision would be in line with the Developer Contributions SPD.

- 5.14 **NHS England** - NO OBJECTIONS - Additional patients generated by the development will likely have an impact on the NHS funding programme for the delivery of primary healthcare provision within this area and specifically within the health catchment of the development. There are 3 GP Practices within a 3km radius of the site. These practices do not have sufficient capacity for the additional growth resulting from this development and cumulative development growth in the area. CIL funding may be sought in the future to assist with the delivery of new infrastructure for the provision of primary healthcare services in the GP Catchment Area. It is noted that the development is not of a size and nature that would attract a specific S106 planning obligation.
- 5.15 **Natural England** - NO OBJECTIONS - With regards to the impact upon Statutory Nature Conservation Sites. Based on the information submitted, the proposal is unlikely to affect any statutorily protected sites or landscapes. With regards to protected species, Natural England Standing Advice should be applied to this application.
- 5.16 **RSPB** - The reserve being created through the Hanson RSPB Wetland Project is within easy access of the site. This should not substitute high quality, accessible and wildlife rich green space that should be provided alongside new developments. It is noted that 43% of the site is to be green space. The opportunity to discuss the matter of managing potential consequences of the application for the Ouse Fen Reserve would be welcomed. Attention is drawn to guidance to inform the detailed design stage.
- 5.17 **Wildlife Trust** - NO OBJECTIONS - I am pleased to see that the RSPB has been consulted for their views on potential impacts on RSPB Ouse Fen. Provided the RSPB are satisfied with the proposed mitigation measures, I have no further comments to make on this issue. The outstanding survey information has now been provided. The bat survey identified further mitigation measures and the need for an EPS licence (see section 5.28 of the amended EclA). As I had previously advised, these additional measures will need to be added to the existing mitigation proposals and secured by way of a suitably worded planning condition. I welcome the commitment to the production of a site-wide biodiversity/ecological mitigation and management strategy.

6. REPRESENTATIONS

- 6.1 15 OBJECTIONS have been received from 14 residents. The objections can be summarised as:

Policy Matters -

* Within policy CS3 of the Core Strategy 2009 Needingworth is identified as a Small Settlement where residential infilling within the built up area of up to three dwellings is appropriate. The development is contrary to this policy.

* According to Policy CS3, the development is 'large scale development'. Insufficient justification has been provided to permit the development as an exception.

* Needingworth is identified as a Smaller Settlement because it has a limited range of services and facilities and is not therefore a sustainable location for the size of development proposed.

- * The development would increase the size of Needingworth by over 10%, harming the character of the village.
- * The level of development taking place in Needingworth, proposed under this application and on adjacent land 17/01077/FUL is too great.
- * Only 40% of the dwellings would be affordable, defeating the need for affordable housing.
- * The proposal would extend beyond current village boundary and would act as a precedent for further such expansion.
- * A need for the proposed development on land outside the Needingworth village boundary has not been demonstrated. If a larger number of homes are needed locally, there are probably suitable infill sites within the village boundary.
- * Insufficient detail provided regarding dwelling numbers.
- * The density of the development would be different to the rest of the village.
- * The site is greenfield and not suitable for development.

Flooding and Drainage -

- * Local sewage arrangements are at capacity and cannot cope with further development; major works may be needed to accommodate the scale of development proposed.
- * The site is prone to flooding. Development of the land will exacerbate this.
- * Insufficient detail provided regarding drainage.

Highways -

- * The traffic survey undertaken was completed at the start of the summer holiday and is therefore inaccurate and not representative of a typical day.
- * The traffic assessment must have been undertaken outside of peak traffic periods, when there were no issues with the A14 and when Earith Bridge was open as it does not reflect the traffic experienced in these situations.
- * Within the Transport Assessment, the assumptions made regarding the numbers of cars resulting from the development are inadequate and result in an underestimation of vehicles and vehicle movements resulting from the development.
- * Changes to the current status of the road and pathways will be required given the two vehicular and pedestrian accesses proposed.
- * Will increase the traffic on local road network by approx. 240 cars, exacerbating existing congestion on A1123, often queuing back from St Ives to Needingworth and associated junctions.
- * Has the capacity of the A1123 been tested?
- * The development is located a dangerous junction where fatalities have occurred.
- * Within the Transport Assessment, the number of vehicles from the development turning right from Bluntisham road onto A1123 is not representative. Higher numbers of vehicles would likely turn right to avoid congestion in St Ives.
- * Highway safety concerns regarding A1123/Bluntisham Road junction and business of this junction.
- * Proportion of vehicles turning right out of the development underestimated as Bluntisham Road/A1123 junction is difficult to negotiate.
- * The Traffic Assessment does not take account of the existing excessive congestion.

- * Access into the site from a 60mph road would be dangerous. Traffic calming would be required.
- * Residents of the development will rely on cars for transport unless improvements are made to public transport. Bus services are limited and their future is uncertain. The cycle times quoted in the Travel Plan are ambitious; underestimating the length of time journeys would likely take.
- * Would increase traffic parking outside/near the primary school, exacerbating existing parking problems.
- * Existing transport infrastructure, including the junction of the A1123 and Bluntisham Road, requires modification to accommodate the number of cars resulting from the development.
- * The Transport Assessment does not take account of the opening of Morrisons/Mcdonalds developments at the Compass Point/Marsh Harrier roundabout at the western end of the A1123. In addition, it does not take account of developments at Giffords Farm. These developments will worsen the situation.
- * There could be a conflict with quarry traffic (sand & gravel lorries) and vehicles from the development.
- * Would increase traffic through Needingworth village.
- * Would create additional traffic through St Ives and villages trying to access A14.
- * There should be no further development to the north of the Great Ouse until traffic issues through St Ives and surrounding villages is resolved.
- * There is not a designated cycle path to the other end of Needingworth such to access the cycle path to St Ives.
- * Existing bus services are not adequate to access local services and get to work; therefore all occupiers will require cars.
- * The proposed access is close to a bend in the road.
- * The Transport Assessment does not provide passenger numbers for the bus services.
- * Car parking within the scheme is inadequate, making it difficult for pedestrians and emergency vehicles.
- * There are no public pavements that extend from the development to facilitate access to services and facilities within the village.

Infrastructure-

- * The development will place a considerable load on local infrastructure.
- * There are insufficient facilities in the village to sustain the scale of development proposed.
- * The Travel Plan and Transport Assessment misrepresents healthcare facilities within the village; there is not a GP practice, only a private physiotherapy clinic. The nearest medical services are in St Ives and these are at capacity or oversubscribed.
- * Holywell Primary School cannot accommodate the number of children resulting from the development. Children will therefore have to travel to other villages to school.
- * The Primary School is situated on a constrained site and is too small to cope with the additional children from 120 households.
- * St Ivo secondary school is oversubscribed and is unlikely to provide sufficient places. The catchment is also changing.
- * Insufficient capacity at local dentists practices.
- * Insufficient capacity at local doctors surgeries.

- * Permission has been granted for 14 dwellings in the village. Existing infrastructure and services will not be able to cope with further development of the scale proposed.
- * Mix of dwellings supported but adequate infrastructure must be put in place first.
- * The existing bus services are inadequate and are under threat so occupiers would have to use cars routinely.

Amenity & Community -

- * An alternative to the Cambridge News for advertisement of the consultation event should have been used such as a free paper or leaflet as residents do not purchase this paper.
- * Appendix A of the Statement of Community Involvement is not visible online.
- * The proposed play area is not located in accordance with ROSPA guidelines or the Open Space SPD. There is insufficient opportunity for surveillance and may lead to anti-social behaviour and children feeling/being unsafe.
- * The development would be overbearing and out of character with the undeveloped character of the area which includes the RSPB Ouse Fen Reserve.
- * The development would not benefit Needingworth.
- * The development would turn Needingworth into a large settlement.
- * The location of the development will tend to isolate the new homes from the main part of the village, affecting children going to the school and prevent residents from feeling a sense of belonging to the community of Needingworth.
- * Insufficient detail provided regarding the potential for integration of the development into the village.
- * The site is far away from the rest of the village so will be isolated.
- * The amount of affordable housing will turn out to be a much smaller percentage than has been proposed.

Environment & Ecology -

- * The development would significantly alter the green character of the north-east end of the village.
- * Despite the findings of the Ecological Impact Assessment Report, brown hares live in the area and should be taken into account.
- * Loss of habitat
- * The application makes inadequate provision for wildlife

Other (non-planning) Matters -

- * The proposal is generic and does not seem to be what is needed for Needingworth.
- * The development is just the tip of the iceberg should Gifford's Farm be developed too.
- * Comments have taken a notable period of time to appear on the Council's website.

7. ASSESSMENT

- 7.1 As set out within the Planning and Compulsory Purchase Act 2004 (section 38(6)) and the Town and Country Planning Act 1990 (section 70(2)) in dealing with planning applications the Local Planning Authority shall have regard to the provisions of the development plan, so far as material to the application, and to any other material

considerations. This is reiterated within paragraphs 2, 11, 196 and 210 of the NPPF. The development plan is defined in section 38(3)(b) of the 2004 Act as "the development plan documents (taken as a whole) that have been adopted or approved in that area".

- 7.2 In Huntingdonshire the Development Plan consists of:
- Saved policies from the Huntingdonshire Local Plan 1995 (Parts 1 and 2)
 - Saved policies from the Huntingdonshire Local Plan Alteration 2002
 - Adopted Core Strategy 2009
 - Huntingdon West Area Action Plan 2011
 - Cambridgeshire & Peterborough Minerals and Waste Development Plan Core Strategy
 - St Neots Neighbourhood Plan
 - Godmanchester Neighbourhood Plan
 - Houghton and Wyton Neighbourhood Plan

- 7.3 The statutory term 'material considerations' has been broadly construed to include any consideration relevant in the circumstances which bears on the use or development of land: *Cala Homes (South) Ltd v Secretary of State for Communities and Local Government & Anor* [2011] EWHC 97 (Admin); [2011] 1 P. & C.R. 22, per Lindblom J. Whilst accepting that the NPPF does not change the statutory status of the Development Plan, para 2 confirms that it is a material consideration and significant weight is given to this in determining applications.

- 7.4 The main issues to consider in assessing this application are if this development is considered sustainable development, having considered the economic, environmental and social elements of this case. With that in mind the matters for further discussion are those of the principle of development (including loss of agricultural land, proposed use and amounts), indicative layout, access and transport, heritage assets, trees and landscape, ecology and biodiversity, ground conditions and contamination, noise and pollution, flooding and drainage, waste, infrastructure requirements and planning obligations.

Principle Of Development:

Development Plan

- 7.5 Needingworth is defined as a 'Smaller Settlement' in Policy CS3 of the Core Strategy (2009). The Core Strategy sets out that further to Market Towns and Key Service Centres, "Huntingdonshire has a great many other villages of varying size and character all offering different levels of services and facilities to their residents. These are classed as Smaller Settlements in the third tier of the hierarchy". It is outlined that "the main distinction between these Smaller Settlements and the Key Service Centres is that none offer a sufficient range of services and facilities to sustain daily living without the need to access services and facilities elsewhere". As a result, policy CS3 of the Core Strategy sets out that for Smaller Settlements "residential infilling will be appropriate within the built-up area"; with 'residential infilling' indicated as being up to 3 dwellings within the built-up area. The policy also provides that development proposals of a larger scale

may be allowed where specific circumstances demonstrate that this secures the most sustainable option for the site.

- 7.6 The Development Plan policies seek to ensure that development is located in places well served by public transport and accessible to services so that the need to travel is minimised, thus helping to tackle climate change at a district level. For this reason, and to restrict the loss of high quality agricultural land and to help protect the character of the countryside, development outside the built up area is carefully controlled. Development outside the built up area is restricted, for example to dwellings required for the efficient management of agriculture, forestry or horticulture enterprises (policies En17 and H23 of the 1995 Local Plan apply). Building on this, Policy CS3 of the Adopted Core Strategy continues the strategic aim of concentrating development in the larger sustainable settlements and protects the character and scale of smaller villages and the countryside through limiting general housing development outside of the built up area (with the exception of essential needs housing and specific allocations). Policy CS2 of Core Strategy 2009 which operates at a higher level than CS3, does not provide for housing development on the application land.
- 7.7 Paragraph 49 of the NPPF states that housing applications should be considered in the context of the presumption in favour of sustainable development and paragraph 55 of the NPPF gives importance to promoting sustainable development in rural areas. However, the NPPF has a slightly more positive approach to development in the countryside than the restrictive development plan policies on housing in the countryside. Furthermore, an overall aim of the NPPF is to significantly boost housing supply. As such, there is an inconsistency with policies H23, En17 and CS3, and the thrust of the NPPF. In accordance with paragraph 215 of the NPPF the weight to be given to these policies should be reduced. Paragraph 14 of the NPPF requires that where relevant policies are out of date, permission should be granted unless 'any adverse impact of doing so would significantly and demonstrably outweigh the benefits, when assessed against the policies in this framework taken as a whole: or specific policies indicate development should be restricted.'

Emerging Plan

- 7.8 Huntingdonshire's Local Plan to 2036: Proposed Submission 2017 (as amended March 2018 for submission) Needingworth is defined as a 'Small Settlement' within the emerging Local Plan to 2036. Policy LP 11 of the Local Plan to 2036 Proposed Submission 2017 sets out that development within the countryside will be restricted to the limited and sporadic opportunities as provided for in other policies of the plan. Amongst other requirements, this policy outlines that development must protect the intrinsic character and beauty of the countryside and not give rise to noise, odour, obtrusive light or other impacts that would adversely affect the use and enjoyment of the countryside by others.
- 7.9 Policy LP 10 of the Local Plan to 2036: Proposed Submission 2017 (as amended March 2018 for submission) sets out that residential development would be supported within a Small Settlement where it is appropriately located within the built-up area and where the amount

and location of the development proposed is sustainable in relation to the:

- level of service and infrastructure provision within the settlement;
- opportunities for users of the proposed development to access everyday services and facilities by sustainable modes of travel including walking, cycling and public transport;
- effect on the character of the immediate locality and the settlement as a whole.

7.10 With regards to development on land well-related to the built-up area, it is set out that development may be supported where it accords with the specific opportunities allowed for through other policies within the plan.

7.11 In taking account of Paragraph 216 of the NPPF, the LPA considers that at this point in time, in considering policies for the delivery of housing, greater weight should be attributed to policies within the Development Plan than to emerging policies within Huntingdonshire's Local Plan to 2036: Proposed Submission 2017 (as amended March 2018 for submission).

Application Site - Policy Assessment

7.12 Having regard to paragraph 55 of the NPPF, the application site is not considered to be 'isolated' by virtue of its location within 250m of Needingworth (from the proposed access point to the edge of the settlement) and the presence of dwellings immediately east of the site to the opposite side of Bluntisham Road. However, the application site is outside of the built-up area of Needingworth and is not allocated for development within the Local Plan 1995/2002 or the Core Strategy 2009. The site is therefore considered to be in the countryside for the purposes of the Development Plan. Being within the countryside, development of the site, as proposed, is contrary to Development Plan policies H23 and En17 of the Local Plan (1995) and policy CS3 of the Adopted Core Strategy (2009). The application has been advertised as a departure from the Development Plan as it is contrary to the Development Plan currently in place for Huntingdonshire, due to the application site being outside of the built up area of Needingworth and forming part of the countryside.

7.13 It is noted that residential development on the site is also contrary to policy LP10 of Huntingdonshire's Local Plan to 2036: Proposed Submission 2017, by virtue of the location of the application site, outside of the built up area.

7.14 As referred to above, applications must be determined in accordance with the Development Plan unless material considerations indicate otherwise. It therefore needs to be established whether there are any material considerations that indicate that the application should be approved as a departure from the Development Plan.

Housing Supply and Tilted Balance

7.15 In order to satisfy the requirements of the NPPF to boost housing supply the Council must demonstrate an up-to-date five year supply of deliverable housing sites to meet its objectively assessed need,

with an additional buffer to ensure choice and competition in the market for land; this requirement is set out in paragraph 47 of the NPPF. Due to under delivery in recent years the buffer to be applied for the District is 20%. The December 2017 Annual Monitoring Review applies the 20% buffer and demonstrates that the Council has a five year supply of housing land. Whilst the Council has a five year supply of housing land, it is acknowledged that the 5 year supply is a minimum amount of land to be made available and does not seek to represent a cap on development.

7.16 As previously identified, the Development Plan policies relevant to the supply of housing (En17 and H23 of the Huntingdonshire Local Plan (HLP) and CS2 and CS3 of the Huntingdonshire Core Strategy (HCS)) were set against a lower Objectively Assessed Need figure such that strict application of these policies alone would result in failure to achieve the objectively assessed housing need figure that the Council currently has identified as part of the emerging Local Plan to 2036. As a result, the aforementioned policies within the development plan are no longer considered to be fully up-to-date or consistent with the NPPF and, at this time and until the Council adopts the Local Plan to 2036 with up-to-date policies, the 'tilted balance' as set out within the 4th bullet point of para. 14 of the NPPF is engaged. For decision-taking this means granting permission in instances where the Development Plan is absent, silent or relevant policies are out-of-date unless any adverse impacts would significantly and demonstrably outweigh the benefits (having regard to the Framework policies taken as a whole), or specific policies of the Framework indicate development should be restricted. It is however noted that the aforementioned policies within the Development Plan relevant to the supply of housing should not be disregarded; on the contrary, even 'out-of-date' policies remain part of the Development Plan, and the weight attributed to them is a judgment for the decision maker and will vary according to the circumstances.

7.17 To address the identified shortfall in housing delivery, Huntingdonshire's Local Plan to 2036 contains a significantly revised strategy from the Adopted Core Strategy (2009). The strategy for development in the District is set out in Policy LP 2 of the emerging Local Plan to 2036 and focuses on concentrating growth in the four identified Spatial Planning Areas, with approximately three quarters of the objectively assessed need for housing being focused within these areas. Working down the settlement hierarchy identified within Policy LP2, seven Key Service Centres are designated, reflecting the concentration of services and facilities in these settlements; serving not only residents of these settlements but also residents of other nearby communities. Following on from this, three Local Service Centres are identified, reflecting the level of service provision available to residents. Working further down from this, the role of small settlements is identified. Policy LP 2 notes that "Approximately a quarter of the objectively assessed need for housing, together with a limited amount of employment growth, will be permitted on sites dispersed across the key service centres, local service centres and small settlements to support the vitality of these communities and provide flexibility and diversity in the housing supply". Policy LP 10 provides support for development proposals within the built-up area of a Small Settlement. The emerging Local Plan to 2036 has been submitted for examination and as such, in accordance with paragraph

216 of the NPPF, it is considered that moderate weight can be attributed to housing supply policies within the emerging Local Plan. It is acknowledged that the application site is not identified for allocation within the emerging Local Plan to 2036 and falls outside the built-up area of a Smaller Settlement. As such, the proposals would not accord with policies within the emerging Local Plan to 2036.

- 7.18 It is accepted that the NPPF supports a genuinely plan-led approach, and that this has been reinforced by a 2016 Court of Appeal decision. However, as set out above, it is also a core principle of the Framework that plans are kept up-to-date. As such, the above-noted countryside protection policies are not capable of meeting the level of housing need that is now identified by the Local Planning Authority. These factors significantly reduce the weight that can be afforded to the above-noted policy conflicts in the present proposal.
- 7.19 The application proposes affordable housing provision at 40% to be secured through Section 106 Agreement. Although the 40% affordable housing provision is welcomed, it is highlighted that it is a policy compliant provision and therefore accords with what should be expected on all qualifying sites. Notwithstanding this, it is acknowledged that the LPA has not achieved target levels of affordable housing in the past and there is a substantial backlog of need. Therefore, whilst this development is only seeking to provide policy compliant levels of affordable housing, this does equate to up to 48 units (as the development seeks up to 120 dwellings) and would provide over 15% of the annual target for the District. This therefore adds significant weight in favour of the proposal.
- 7.20 As can be seen from the above paragraphs, the proposed 40% affordable housing provision does have social benefits, however the proposed development must be considered alongside the three dimensions of sustainable development as set out within the NPPF; economic, social and environmental. The economic and environmental factors are considered in detail within the proceeding sections of this report.

Loss of Agricultural Land

- 7.21 The NPPF advises in para. 112 that the economic and other benefits of best and most versatile agricultural land (BMV land) should be taken into account and that where significant development of agricultural land is demonstrated to be necessary, LPAs should seek to use areas of poorer quality land in preference to that of higher quality. Annex 2 of the NPPF defines BMV land to be land in Grades 1, 2 and 3a of the Agricultural Land Classification.
- 7.22 Policy LP 11 of Huntingdonshire's Local Plan to 2036: Proposed Submission 2017 sets out that: "Development in the countryside will be restricted to the limited and specific opportunities as provided for in other policies of this plan. All development in the countryside must:
- a. seek to use land of lower agricultural value in preference to land of higher agricultural value:
 - i. avoiding the irreversible loss of the best and most versatile agricultural land (Grade 1 to 3a) where possible, and

- ii. avoiding Grade 1 agricultural land unless there are exceptional circumstances where the benefits of the proposal significantly outweigh the loss of land;
- b. protect the intrinsic character and beauty of the countryside; and
- c. not give rise to noise, odour, obtrusive light or other impacts that would adversely affect the use and enjoyment of the countryside by others".

- 7.23 The Council's Local Plan to 2036 - Sustainability Appraisal (SA) Scoping Report, sets out that there is little brownfield land in the District and that some 79% of the brownfield land within the District is located at former RAF bases at Alconbury and Upwood, which are proposed allocations for development of mainly housing, with the land at Alconbury benefitting from outline planning permission. This Scoping Report explains the strong agricultural history of the District, with most of Huntingdonshire comprising of good quality agricultural land, mostly classed as grade 2 with only small areas classed as grade 4.
- 7.24 Para. 3.11 of the SA Scoping Report sets at that 98% of all agricultural land in the District is classed as grades 1, 2 or 3, with 15% classed as grade 1. The SA scoping report does not differentiate between grades 3a and 3b, and therefore to determine a percentage for BMV land some assumptions have to be made. The proportion of BMV land is estimated at 77%, derived as follows: take 15% off 98% to give the percentage of land within grades 2 and 3 (83%), assume an equal split between grades 2 and 3 (41.5% each) and between grades 3a and 3b (20.75% each), take the grade 3b away from the overall 98% gives 77.25%.
- 7.25 The proposal seeks a permanent change in land use and the subsequent loss of agricultural land. The Council's mapping system classifies the application site as a combination of grade 2 and grade 3 agricultural land. The proposal would entail the loss of approximately 6.44 hectares of agricultural land; approximately 2.84 hectares of Grade 2 agricultural land and approximately 3.6 hectares of Grade 3 agricultural land. Of the land classed as Grade 3, approximately 2.4 hectares of this consists of a poultry farm, formed of a number of poultry sheds, related buildings and an associated agricultural dwelling. In considering the proposal against Policy LP 11 of the emerging Local Plan to 2036, the proposed development would not lead to the loss of any Grade 1 agricultural land.
- 7.26 It is considered that the loss of agricultural land is largely inevitable if housing is to be provided within this rural district and as such has to be considered in the planning balance. In this regard, it is accepted that the proposal would lead to loss of BMV land, however due to the size of the site (approx. 6.44 ha), it is not considered that the proposed development is 'significant' in the context of the para. 112 of the NPPF when taking into account the threshold for consultation with Natural England is 20ha of BMV land proposed for development. Consequently, the proposal is not considered to conflict significantly with part a. of policy LP 11 of Huntingdonshire's Local Plan to 2036: Proposed Submission 2017. Notwithstanding this, the site has few physical constraints and so may be considered technically suitable, the site is also available, the proposed development achievable, and therefore it can be reasonably assumed it is deliverable.

Indicative Layout And Scale Parameters:

- 7.27 Whilst the application is in outline only, to allow full evaluation and consideration of the development, to determine whether the proposed amount of development can be satisfactorily accommodated on the site, an indicative Development Framework Plan has been provided to demonstrate the potential location of residential development, routes and open spaces. In addition to this, an 'Illustrative Masterplan' (included within the Design and Access Statement) has also been submitted, providing additional detail of how development could be arranged within the site. The submitted indicative Development Framework Plan and Illustrative Masterplan are attached to this report.
- 7.28 The illustrative Development Framework Plan provides an indication as to how land uses within the site could be laid out in order to achieve both the quantum of development and necessary supporting infrastructure e.g. roads, open space and drainage. Although only indicative at this time, the Illustrative Masterplan provides further details, demonstrating how the proposed quantum of development could be achieved through a mix of detached, semi-detached and terraced properties, accessed via a mix of adopted and private roads. A spine street is shown which would form a 'loop' arrangement, with secondary streets and private drives extending from this. Dwellings along the western boundary are looser knit to respect the transition into open countryside with a tighter grouping of houses set centrally and through the site.
- 7.29 The indicative Development Framework Plan indicates the retention of existing vegetation, as well as additional tree planting and hedgerow planting along the boundaries of the site; maintaining the current enclosed and screened character of the site.
- 7.30 Cycle routes and recreational routes are indicated within the site which could encourage walking and cycling. Proposed new cycle and pedestrian routes are also shown, linking into the site from Bluntisham Road, which would assist with connectivity and permeability to the services and facilities within Needingworth. These links are shown on the submitted access plans and a condition can ensure these links are provided within an appropriate timescale of the development.
- 7.31 The indicative Development Framework Plan also demonstrates that 2.73 hectares of open space could be satisfactorily provided alongside the quantum of development proposed and areas for biodiversity enhancements could also be secured within the open space and around the perimeter of the site; including the planting of new hedgerows and trees.
- 7.32 The submitted plan within the Design and Access Statement 'Layout Principles' indicates that 120 units could be accommodated within a scheme of low and medium density housing of predominantly 2 storey properties, with some 2.5 storey units. Notwithstanding this,

the scale would be carefully considered in detail as part of the relevant reserved matters submission and alongside details such as the housing mix, design and levels. The density of development as shown on the indicative plan within the Design and Access Statement is around 32 dwellings per ha, based on the indicative layout and quantum of development proposed. One of the aims of the NPPF and local policy is to provide a mix of housing to meet a range of needs, whilst having regard to local need. To enable this, Policy HL6 of the Huntingdonshire Local Plan Alteration (2002) supports housing densities ranging from 30 to 50 dwellings per hectare. It is noted that the adjacent scheme recently consented on 'Land between Victoria House and Fairview Bluntisham Road' to the south of the application site (ref: 17/01077/FUL) is around 31 dwellings per hectare and that the density of development varies throughout the village, with some areas being of much lower density than proposed, whilst others are broadly comparable. The proposal for an average of 32 dwellings per hectare would accord with Policy HL6, whilst enabling the development to respond to rural setting of the site. As such, whilst the variation in housing densities within Needingworth village is noted, it is considered that the proposal of 32 dwellings per hectare is not uncharacteristic to the area.

- 7.33 The indicative layout shown on the Development Framework Plan and Indicative Masterplan within the Design and Access Statement could benefit from the widening of the green corridors running from east to west across the site, such to form useable amenity spaces rather than being formed of predominantly hedging and meaningfully contribute to the overall on site open space provision, as well as acting as valuable ecological features. However, it is concluded that the general layout could be made to be acceptable for reserved matters applications, and would adequately achieve the quantum of development proposed and the associated infrastructure. Therefore, whilst the indicative layout shown on the Development Framework Plan is not fully supported, the quantum of development and necessary supporting infrastructure is considered to be achievable. The 'appearance', 'landscaping', 'layout' and 'scale' and would be considered in detail as part of reserved matters should outline permission be granted.

Trees, Open Space and Landscape and Visual Impact Assessment:

- 7.34 Paragraph 17 of the NPPF states that planning should take account of the different roles and character of different areas, including recognising the intrinsic beauty of the countryside. Paragraph 58 of the NPPF states that planning policies and decisions should respond to local character and history.

Trees:

- 7.35 The application is supported by a Tree Survey including an Indicative Tree Retention and Removal Plan undertaken by CSA Environmental. The Indicative Tree Retention and Removal Plan submitted within the Tree Survey Report has not been updated during the lifetime of the application, with the most up to date proposals for tree removal being shown on the Development Framework Plan.

- 7.36 It is noted that none of the trees within the application site are protected by Tree Preservation Orders. The submitted Tree Survey identifies that there are a number of tree groups located within the northern part of the site as well as a numerous hedgerows running across the interior of the site. These are classified as Category B. A number of single trees and groups of trees are dispersed throughout the site and the presence of fruit trees within linear rows, within the southern part of the site, is noted as potentially forming a remnant orchard. The application site is also bound by lengths of hedgerow running around the perimeter, with a number of large trees interspaced with the hedge along the eastern site boundary to Bluntisham Road.
- 7.37 The submitted Tree Survey advises that the hedgerows defining the outer boundary of the site do not necessarily pose a constraint to the proposals, although it is noted that their retention (with appropriate management and restocking) would help provide a strong landscape buffer to the application site. With regards to the trees within the site, the Tree Survey concludes that most of the Category B trees in the site's interior are relatively small and their loss could be readily mitigated through new tree planting. Three sizeable trees are present along the eastern site boundary, immediately adjacent to the existing access point to the poultry farm. These trees consist of a Weeping Willow (Category C1) and two large Hybrid Black Poplar trees (Category B1). The Tree Survey notes that a number of large limbs to the Black Poplar trees had recently failed and that due to the age and growth strategy of poplars, it is likely that such failures would occur more frequently in the future. The submitted Development Framework Plan indicates that these trees would be removed to facilitate provision of the vehicular access point. The Tree Survey also sets out that T27; a large, mature Horse Chestnut located in the far south of the site should be retained and adequately accommodated such to prevent construction impacts to the tree.
- 7.38 Development of the site would also necessitate the removal of a number of existing single trees and groups of trees within the site, as well as the loss of some of the hedging running from east to west across the site. In addition, as aforementioned, the proposal would necessitate the removal of three sizeable trees along the eastern site boundary to facilitate the proposed vehicular access point.
- 7.39 The Council's Tree and Landscape Officer considers that the submitted arboricultural documents are acceptable, but has relayed that the retention of Willow T1, proposed for removal to facilitate the proposed access point, would be preferential. Within the submitted Tree Survey, the Willow tree (T1) is identified as category C1. Whilst the loss of any trees is regrettable, the tree is not considered to be of particular merit, such to warrant protection and resist its loss. On balance, it is therefore considered that the proposal is acceptable with regards to the impact upon trees, subject to the imposition of a condition requiring the submission of an Arboricultural Method Statement; given that the submitted Indicative Tree Retention and Removal Plan is out of date. The Arboricultural Method Statement (AMS) will be required to include final tree surveys, schedule and timing of works, details of tree/hedge protection, methods of construction close to trees and the location of service trenches. Whilst the precise extent of tree removal is yet to be determined, Officer

would anticipate that development coming forward at reserved matters stage would accord with the principles set out within the submitted Development Framework; such to ensure the retention of vegetation around the periphery of the site and within the site, in the interests of visual amenity and biodiversity. The AMS would be required alongside any reserved matters submission for layout, landscape or scale, to ensure that the trees and hedges would be satisfactorily protected to facilitate their retention.

Open Space:

- 7.40 Based on the submitted Development Framework Plan, 2.73 hectares of formal and informal open space would be provided on site; including approximately 0.5 hectares of attenuation areas. This is a significant over-provision from the Developer Contributions SPD requirements of 0.572 hectares. To compensate for the loss of hedges and trees, an orchard, replacement planting and the strengthening of retained hedges are proposed. These would largely be accommodated within the areas of public open space within the site.
- 7.41 During the lifetime of the application, the layout of the development (as shown by the Development Framework Plan and Illustrative Masterplan) was revised in response to comments from consultees, including those of the Council's Green Spaces Officer and within the representations from neighbouring properties. Following revisions to the layout, it has been indicatively shown that sufficient land for a children's play area could adequately be accommodated and be accessible within the development. It has therefore been demonstrated that the open space requirements of the Developer Contributions SPD could readily be achieved alongside the amount of development proposed. The precise open space details would be established through the S106 agreement and reserved matters details. In accordance with the Developers Contributions SPD (2011) and as this scheme is not a large scale major residential development of 200 units or above, it is not necessary for an on-site equipped play area to be provided (but the necessary quantum of space should be secured).
- 7.42 The trees and open space proposed as part of the development is considered to be compliant with the NPPF and policies R1, R2, R3, R7, R8, R12, En18, En19 and En20 of the Local Plan 1995, policy CS10 of the Core Strategy 2009 and LP3 and LP 33 of the Proposed Submission 2017 Local Plan to 2036.

Landscape and Visual Impact Assessment:

- 7.43 The immediate setting to the site is defined by the A1123 to the north and Bluntisham Road to the east.
- 7.44 The application is supported by a Landscape and Visual Impact Assessment prepared by CSA Environmental in July 2017.
- 7.45 The site is located just within the Central Claylands Landscape Character Area (LCA) but also on the border of the Ouse Valley LCA, as defined by the Huntingdonshire Landscape and Townscape

Assessment (2007). The local landscape in and around the site takes its characteristics from both of these LCAs.

- 7.46 The Landscape and Visual Appraisal has been assessed by Officers and is found to be acceptable in terms of methodology and conclusions, namely;
- *The Site is very well contained in views from the surrounding area, particularly in views from the north, east and south. The mature vegetation to the site boundaries is a positive feature, providing screening of the application site.
 - *There are no public footpaths which cross the application site and there will be no direct effects on the rights of way network.
 - *The proposal would be a major alteration to the character of the site, but there would be a limited impact on the surrounding area, with a slight adverse effect when considered in the context of Bluntisham Road and a neutral effect when considered in the context of the surrounding countryside.
 - *The proposal to develop the site constitutes a high magnitude of change, which would have a moderate adverse effect, but reducing to a slight adverse effect as landscape enhancements mature.
 - *The removal of two internal field hedgerows and sections of hedgerows within the site constitute a high magnitude of change; resulting a moderate adverse effect on the landscape. The loss of hedgerow would however be mitigated by new planting.
 - *The removal of trees and vegetation within the site constitute a medium magnitude of change; resulting in a slight adverse effect on the landscape, but altering to beneficial effect as new and replacement landscaping matures.
 - *The effect on the Landscape Value would be neutral.
 - *There would be views of the rooflines of the development in the southern part of the site, over the retained hedgerow, from the two neighbouring properties to the south. The development would be partly visible but given the intervening vegetation and separation distances, uninterrupted views would broadly be from first floor windows only.
 - *In views from the two properties located to the north east of the site on Bluntisham Road, some roof lines of the development would be visible above the existing tall hedgerows. Filtered views of housing would be available in the winter months when the deciduous vegetation has dropped its leaves. There would also be oblique views towards the vehicular access point.
 - *One of the main receptor groups outside the site is passing traffic; along the A1123 and Bluntisham Road.
 - *Perimeter vegetation and the lack of public vantage points mean that the site is usually only glimpsed by visual receptors, with very limited direct views available from the A1123. Glimpsed, filtered views of the development would be possible from vehicles traveling along the A1123, generally during the winter months when the vegetation is out of leaf. These views will be transitory. The proposal would have an insignificant adverse visual effect on views from along the A1123.
 - *In views from Bluntisham Road, the development would be well screening by the existing hedgerow and trees, with the exception of the points of access. There would be glimpsed views of rooflines above the hedgerow and filtered views in winter when the vegetation is out of leaf. These views will be transitory. At the proposed access points (vehicular and pedestrian) the proposal would have a moderate adverse visual effect on views from the approach along

Bluntisham Road. Along the remainder of the boundary, a slight adverse visual effect would result.

*Views from the Public Right of Way leading from Bluntisham Road to the RSPB Ouse Fen Nature Reserve are limited to the tree hedgerow which extends alongside the western edge of Bluntisham Road.

*There would be heavily filtered views of rooflines within the Site from the bridleway which crosses the countryside to the east. These will be seen in the context of existing housing on the edge of the village and will largely be screened by vegetation along the route of Bluntisham Road.

*Views of the site from within the Ouse Fen Nature Reserve are unavailable owing to intervening vegetation.

*There are no views of the site from the footpath extending to the north west of Needingworth due to intervening vegetation.

*Views of the site from Lowndes Drove are prevented by vegetation along the route of the A1123.

*In long distance views, there is a panoramic view available from higher ground on Bluntisham Heath Road, west of Bluntisham, however the site is not discernible.

*The site is well contained and landscape and visual effects would be very localised.

- 7.47 It is noted that the HDC Trees and Landscape Officer has raised concerns that the submitted LVIA seemingly underplays the extent of vegetation loss; with large areas of scrub, hedgerow and relic orchard proposed for removal. As such, whilst new planting would help to compensate for this loss, in landscape terms, it is considered that the loss of the hedgerows within the site is a more adverse effect that identified in the submitted LVIA. In addition, it considered that it would be quite some time before the loss of ecological habitat is replaced.
- 7.48 The HDC Trees and Landscape Officer has advised that whilst they disagree with some of the detailed impact assessments, in general terms, it is accepted that the site is well contained. It is also agreed that there would not be significant visual and landscape effects from the residential development of the site of the scale proposed.
- 7.49 It is therefore concluded that with regard to effects on the landscape and visual amenity, the greatest visual effect will be in views on the approach from along Bluntisham Road. The effect would be greatest at the points of access which would afford direct views into the site; resulting in a moderate adverse visual effect. It is however noted that majority of boundary trees and hedgerows are to be retained and as a result, the development would result in a slight adverse visual effect along the remainder of the eastern site boundary. As such, the level of visual effect classed as moderate or more is restricted to views from along Bluntisham Road, at the points of access into the site. The transient nature of these views is noted.
- 7.50 With regards to the impact upon nearby residential properties, it is identified that the development would result in a slight adverse visual effect. Such effects are inevitable given the proposals seeks to urbanise what is a greenfield site, and the limited number of existing properties in the vicinity will therefore experience a marked change in outlook. The extent of these effects are however short term and temporary, this is because in the medium to long term, the effects would reduce through appropriate mitigation planting and sympathetic

offset of proposed residential properties secured as part of reserved matters.

- 7.51 The site is located on the fringes of the settlement of Needingworth, close to existing residential development, such that the proposed development would appear as a continuum of the existing village northward within the confines of the existing road network, rather than as an awkward addition which intrudes upon the open countryside. As such, it is considered that the development of this site will not have an unacceptable impact upon visual amenity and would protect the intrinsic character and beauty of the countryside; in accordance with the aims of the NPPF, policy HL5 of the Local Plan Alterations 2002, policy CS1 of the Core Strategy and criterion b. of Policy LP11 of the Draft Local Plan to 2036: Proposed Submission.
- 7.52 Ultimately, the proposal is considered, in visual impact terms, to comply with the NPPF, policy CS1 of the Core Strategy and criterion b. of Policy LP11 of the Draft Local Plan to 2036: Proposed Submission.
- 7.53 In terms of policy weighing, Policy En25 of the Local Plan 1995; HL5 and HL6 of the Local Plan Alteration 2002; CS1 of the Core Strategy 2009 are all broadly consistent with the NPPF as they support dwellings where the scale, form, materials and design will be sympathetic to the locality; where they achieve an efficient use of land and respect the local pattern of streets and spaces.
- 7.54 These policies can therefore be afforded full weight owing to their consistency with the NPPF. Policies LP2, LP11, LP12, LP13 and LP14 of the Draft Local Plan to 2036: Proposed Submission follow a similar vein and are also considered to be broadly consistent with the NPPF. The policies within the emerging local plan are yet to be subjected to Examination, however when taking account of paragraph 216 of the NPPF, it is considered that the policies can be attributed moderate weight.

Residential Amenity

- 7.55 Policies within the Development Plan, the emerging Local Plan to 2036 and the NPPF seek to ensure developments do not have an unacceptable impact upon residential amenity for both existing and future occupiers/uses.

Future Occupants:

- 7.56 The application site is in close proximity to the A1123 (to the north of the site) and to Bluntisham Road (to the east of the site) which has subsequent impacts with regards to air quality and noise. In relation to these matters, the application is supported by an Air Quality Screening Assessment undertaken by Wardell Armstrong (dated 10 July 2017), a Noise Assessment undertaken by Wardell Armstrong (dated July 2017) and an Addendum Noise Report (dated January 2018).
- 7.57 Air Quality - The Air Quality Screening Assessment outlines that the site is not within an Air Quality Management Area (AQMA), with the nearest AQMA being located approximately 5.5km south-west of the

site in Fenstanton. Therefore, the site is not located within an area of known poor air quality. In assessing air quality, background air pollutant concentrations should be as low as possible. The Air Quality Screening Assessment has reviewed current air quality within the locality and found that the background air pollutant concentrations are notably below the annual mean objectives. As such, the traffic generated by the proposed development would not cause air quality objectives to be approached or exceeded at existing or proposed receptor locations. The impact arising from the development is therefore identified to as 'not significant'.

- 7.58 Odour - In relation to odour, the Air Quality Screening Assessment notes the location of the site approximately 650 metres north of a Sewage Treatment Works (STW). Based on the Council's records, no odour complaints have been received relating to this facility. It is also noted that there are properties situated notably closer to the STW than the proposed development. Overall, it is therefore considered unlikely that there would be any odour impacts on future residents.
- 7.59 Dust - The Air Quality Screening Assessment notes that site specific mitigation measures should be adopted to reduce dust during construction, such to ensure the residual effect falls within the 'not significant' category. The report therefore recommends the submission of a Construction Management Plan to include dust mitigation measures, as recommended in the Institute of Air Quality Management guidance (2014), to prevent dust affecting surrounding sensitive receptors. The Environmental Health Officer agrees with this recommendation and has recommended that a condition is imposed to secure the submission of a Construction Environmental Management Plan, to include a dust mitigation plan, to be agreed in writing by the Local Planning Authority. Subject to the imposition of this condition, the proposed development is considered to be acceptable with regards to air quality impacts.
- 7.60 It is noted that current advice from public health experts advises that the health impacts of Air Quality should be minimised, even if there is no risk that air quality standards will be breached. To take account of this, it is considered that layout of the site to be determined at reserved matter stage, takes account of the proximity of the development to the A1123 through the application of good design and good practice measures, such to reduce the potential impact of current road use on new receptors.
- 7.61 Noise - The application is supported by a Noise Assessment which considers the impacts of noise from adjacent sources, both within the proposed houses and within external amenity areas. Noise modelling based on the Development Framework Plan has been undertaken.
- 7.62 With regard to 'adverse impacts' the NPPF refers to the 'Noise Policy Statement for England' (NPSE), which defines three categories, as follows:
'NOEL - No Observed Effect Level
o This is the level below which no effect can be detected. In simple terms, below this level, there is no detectable effect on health and quality of life due to the noise.
LOAEL - Lowest Observed Adverse Effect Level

- o This is the level above which adverse effects on health and quality of life can be detected.

SOAEL - Significant Observed Adverse Effect Level

- o This is the level above which significant adverse effects on health and quality of life occur'.

- 7.63 The first aim of the NPSE states that significant adverse effects on health and quality of life should be avoided. The second aim refers to the situation where the impact lies somewhere between LOAEL and SOAEL, and it requires that all reasonable steps are taken to mitigate and minimise the adverse effects of noise. However, the requirement to mitigate and minimise the adverse effects of noise does not mean that such adverse effects cannot occur.
- 7.64 The Planning Practice Guidance provides further detail about how the effect levels can be recognised. It is identified that above the NOEL, noise becomes noticeable, however it has no adverse effect as it does not cause any change in behaviour or attitude. Once noise crosses the LOAEL threshold it begins to have an adverse effect and consideration needs to be given to mitigating and minimising those effects, taking account of the economic and social benefits being derived from the activity causing the noise. Increasing noise exposure further might cause the SOAEL threshold to be crossed. If the exposure is above this level the planning process should be used to avoid the effect occurring by use of appropriate mitigation such as by altering the design and layout.
- 7.65 The Noise Policy Statement for England refers to the World Health Organisation (WHO) when discussing noise impacts. The WHO Guidelines for Community Noise 1999 suggest guideline values for internal noise exposure which take into consideration the identified health effects and are set, based on the lowest effect levels for general populations. Guideline values for annoyance which relate to external noise exposure are set at 50 or 55 dB(A), representing day time levels below which a majority of the adult population will be protected from becoming moderately or seriously annoyed respectively. The following guideline values are suggested by WHO:
- o 35 dB LAeq (16 hour) during the day time in noise sensitive rooms
 - o 30 dB LAeq (8 hour) during the night time in bedrooms
 - o 45 dB LAmax (fast) during the night time in bedrooms
 - o 50 dB LAeq (16 hour) to protect majority of population from becoming moderately annoyed
 - o 55 dB LAeq (16 hour) to protect majority of population from becoming seriously annoyed
- 7.66 The British Standard 8233 "Guidance on sound insulation and noise reduction for buildings" 2014 bases its advice on the WHO Guidelines and draws further upon the guideline values with regards to internal and external noise levels. For internal noise, the British Standard 8233 sets out: "Where development is considered necessary or desirable, despite external noise levels above WHO guidelines, the internal target levels may be relaxed by up to 5 dB and reasonable internal conditions still achieved".

7.67 With regards to external noise, the BS8233, 2014 sets out: "For traditional external areas that are used for amenity space such as gardens and patios, it is desirable that the external noise level does not exceed 50 dB LAeq. T with an upper guidance value of 55 dB LAeq. T which would be acceptable in noisier environments. However, it is also recognised that these guideline values are not achievable in all circumstances where development might be desirable. In higher noise areas, such as city centres or urban areas adjoining the strategic transport network, a compromise between elevated noise levels and other factors, such as the convenience of living in these locations or making efficient use of land resources to ensure development needs can be met, might be warranted. In such a situation, development should be designed to achieve the lowest practicable levels in these external amenity spaces, but should not be prohibited". In regard to the BS, whilst adjacent to the strategic transport network, Officers do not consider the application site to be an urban area.

7.68 Within the Addendum Noise Report, noise modelling based on the Development Framework Plan has been undertaken to determine internal and external noise levels.

Noise levels within Houses:

Daytime:

7.69 In accordance with BS8233, the internal noise level in living rooms and bedrooms during the daytime should be no more than 35dB LAeq,16Hour.

7.70 The Addendum Noise Report advises that based on the Development Framework Plan, the daytime external sound level at the majority of proposed facades would be less than 50 dB LAeq, 16h. This indicates for these properties that it would be acceptable to open windows, assuming 15dB attenuation is provided by an open window. However, the daytime external sound level at the facades to properties located along the edge of the built form (to the northern, eastern, southern and north-western edges of the built form) would range from around 50dB to 70dB LAeq,16Hour. The report identifies for properties in these locations, "mitigation measures will be required to achieve guidance noise levels in living rooms and bedrooms during the daytime".

Night-time:

7.71 In accordance with BS8233, the internal noise level in bedrooms at night should achieve 30dBA LAeq,16Hour or less and 45dBA LAMax,F.

7.72 The Addendum Noise Report advises that based on the Development Framework Plan, the calculated noise levels at the facades of the properties, in bedrooms at night, would be less than 45dB LAeq,8Hour 16Hour (or less than Less than 60dB LAMax,F) for the majority of properties. This indicates for these properties that it would be acceptable to open windows, assuming 15dB attenuation is provided by an open window.

- 7.73 The noise levels at the facades of the properties, in bedrooms at night, to properties located along the edge of the built form to the northern, eastern, southern and north-western edges of the built form) would range from around 45dB to 65dB LAeq,8Hour (or around 60 to 80dB LAMax,F). The report identifies for properties in these locations, "mitigation measures will be required to achieve guidance noise levels in bedrooms during the night-time where orange occurs on the façade map".
- 7.74 The submitted Addendum Noise Report identifies that mitigation measures would consist of thermal double glazing and alternative ventilation to opening the windows for noise sensitive rooms; namely bedrooms and living/dining rooms. The report goes on to state that "the implementation of the recommended glazing together with appropriate acoustic ventilation should ensure that the required internal daytime and night-time noise limits are achieved" but notes that "the requirement for acoustic ventilation can be confirmed on a plot by plot basis at the reserved matters stage once detailed layout and elevations plans are available".
- Noise levels in external amenity areas:
- 7.75 With regards to external amenity areas, the BS8233 set out "For traditional external areas that are used for amenity space such as gardens and patios, it is desirable that the external noise level does not exceed 50 dB LAeq. T with an upper guidance value of 55 dB LAeq. T which would be acceptable in noisier environments."
- 7.76 The Addendum Noise Report advises that the lower guideline noise level of 50dB would be achieved in all gardens through the development.
- 7.77 Overall, the Environmental Health Officer concurs with the findings of the Addendum Noise Report; that a noise mitigation scheme is required given the noise levels experienced within the site as a result of the proximity to the local highways network. Consequently, the Council's Environmental Health Officer has recommended that a condition is imposed to secure the submission of a noise mitigation scheme. This should form part any reserved matters submission pursuant to layout, scale or appearance. Subject to the imposition of this condition, the proposed development is considered to be acceptable and complies with the NPPF in this regard, policy H37 of the Local Plan 1995 and policy LP15 of the Local Plan to 2036: Proposed Submission 2017.

Contamination

- 7.78 The application is supported by a Preliminary Risk Assessment. This report identifies the potential for asbestos to be encountered within the soils and stockpiles located on the site, as well as highlighting the presence of fuel tanks on the site. It is also identified that the use of a part of the site for poultry sheds also suggests the potential for pathogens and potentially formaldehyde within the soils in the vicinity of the poultry sheds. Given the potential contaminant sources identified, the Council's Environmental Health Officer has recommended that a condition is imposed to secure site investigation for potential contamination and remediation where required. Subject to the imposition of this condition, the proposed development is

considered to be acceptable and complies with the NPPF in this regard, policy H38 of the Local Plan 1995 and policy LP 15 of the Local Plan to 2036: Proposed Submission 2017.

Existing Occupants/Users:

- 7.79 The existing dwellinghouse within the application site would be demolished to accommodate the proposed development. As a result, the closest neighbouring properties to the application site are Longacre, Enterprise House and The Laburnums; situated approximately 17 metres east of the application site. These properties are separated from the application site by Bluntisham Road. The dwellinghouse 'Fairview' is also situated approximately 25 metres south of the application site, with the rear garden of this property abutting the application site.
- 7.80 The closest residents to the application site will experience a change in outlook, but it should be noted that change does not necessarily equate to harm. In terms of built development, the reserved matters application(s) will fully assess the impacts of matters such as overlooking, overshadowing and loss of privacy. It is however accepted that the quantum of development sought could be accommodated by the application site without significant harm to residential amenity, by virtue of the separation distances to neighbouring properties and boundary planting.
- 7.81 Policies H31, H37 and H38 seek to ensure residential amenity is not harmed as a result of development; the NPPF within the core principles states that planning should "always seek to secure high quality design and a good standard of amenity for all existing and future occupants of land and buildings". These policies are therefore considered compliant with the aims of the NPPF and can be given full weight. Policy LP 15 of the emerging Local Plan to 2036: Proposed Submission also seeks to protect the amenity of future occupiers and the amenities of neighbouring users. Having regard to paragraph 216 of the NPPF, it is considered that significant weight should be attributed to Policy LP 15 of Huntingdonshire's Local Plan to 2036.

Sustainability, Access And Transport:

- 7.82 The NPPF requires all developments that generate significant amounts of movement to be supported by a Transport Assessment (TA) (Para 32). National and local planning policy relating to transport and access promotes sustainable and mixed use development which should give priority to pedestrian and cycle movements, have access to high quality public transport initiatives, create safe and secure layouts and minimising journey times.
- 7.83 Paragraph 32 of the NPPF states that where developments generate significant amounts of movement, decisions should take account of whether opportunities for sustainable transport modes have been taken up, safe and suitable access to the site can be achieved for all people and improvements can be undertaken within the transport network that cost effectively limit the significant impacts of the development. It goes on to state that development should only be

prevented or refused on transport grounds where the residual cumulative impacts of development are severe.

- 7.84 The application is accompanied by a Transport Assessment (TA) prepared by Icen Projects Limited (which has been amended during the consideration of the application following discussions with the County Council, as Local Highway Authority (LHA)). An addendum was also submitted.
- 7.85 The application seeks vehicular and pedestrian access to the site from Bluntisham Road. The proposed vehicular access into the site is detailed as being 5.5m wide with a 2m wide footpath on the southern side. A new footway is detailed to the south of the proposed access on the western side of Bluntisham Road, as well as dropped kerbs and tactile paving areas to provide pedestrian crossing points to either side of Bluntisham Road. This would provide for pedestrian accessibility to the existing footway on the eastern side of Bluntisham Road. The upgrading of the existing footway on the eastern side of Bluntisham Road to a 3m wide shared footway/cycleway to connect the development with the village centre is also proposed as shown on Drawing 12 Rev. C. The LHA has advised that the proposed vehicular access point into the site, with pedestrian footpath to the southern side and visibility splays to be achieved are acceptable, subject to conditions to secure these and their retention. The LHA has also recommended conditions with regards to the specification for the construction of the roads and footways as well as details of proposed management and maintenance arrangements. With regards to the construction process, the LHA has recommended conditions with regards to the provision of wheel wash facilities, facilities for the parking, turning and unloading of vehicles and details of the route for traffic associated with the construction process. The imposition of conditions relating to these matters is considered relevant and necessary. It is noted that the LHA has requested a condition relating to surface water drainage details for the roads and footpaths. This will be addressed through the condition recommended by the Lead Local Flood Authority and therefore need not be repeated.
- 7.86 In considering the impact of the development upon the local highways network, in agreement with the Local Highways Authority, junction capacity assessments were undertaken at the following junctions forming the study area:
- *A1123 Station Road/Bluntisham Road priority junction
 - *St Ives Golf Club/A1123/High Street Roundabout
 - *Stocks Bridge Way/A1123/Harrison Way Roundabout
 - *B1040 Somersham Road/A1123/A1123 St Audrey Lane Roundabout
 - *Parsons Green Lane/ Hunts Sailing Club/Harrison Way Roundabout
 - *A1096 Harrison Way/ Meadow Lane Roundabout
 - *A1096 Harrison Way/ Low Road/ A1096 London Road Roundabout
 - *A1096 London Road/ St Ives Road priority junction
 - *St Ives Road/ Lakes Business Park /A14 Slips Roundabout
- 7.87 With regards to the proposal, modelling has been undertaken to enable an accurate representation of how the junctions operate in both existing and future year scenarios. An increase of +10% in peak hour traffic is widely regarded as material in terms of the impact on highways capacity and represents typical day-to-day variation in traffic flows. The highways impact assessment demonstrates that no

junction within the study area is expected to be impacted by traffic arising from the proposed development by over 7.5%. As such, it is unlikely that the additional traffic generated by the proposed development would be discernible from daily fluctuations on the network.

- 7.88 The assessment undertaken shows that the following will operate above theoretical capacity in the 2022 Base scenario without any additional traffic associated with the proposed development:
*Stocks Bridge Way / A1123 / Harrison Way roundabout,
*B1040 Somersham Rd / A1123 / A1123 St Audrey Ln roundabout,
*A1096 Harrison Way / Meadow Lane, and
*A1096 Harrison Way / Low Road / A1096 London Road roundabout junctions.
- 7.89 The highways assessment shows that when the proposed development traffic is added to these junctions, the impact is minimal.
- 7.90 In terms of the actual number of vehicles trips impacting on junctions operating above practical capacity, the development is forecast to send less than one trip per minute to three of the junctions, less than two trips per minute for another three of the junctions, and less than one trip every two minutes for the remaining three junctions. It is concluded that this level of impact is unlikely to be noticeable across the peak hours.
- 7.91 It is noted that the junction capacity models naturally show an increase in queuing when comparing the 2022 Base and 2022 Development case scenarios, due to the increased traffic flows. However, given that four of the nine junctions are expected to operate above theoretical capacity in both scenarios, it is considered that the queue results should be treated with caution.
- 7.92 CCC Highways as LHA advise that although the development will have an impact on the highways network, its impact would be minimal. CCC Highways advise that as an example, the impact of the development on the Stocks Bridge Way Roundabout would be one car every 1.3 minutes; therefore the impact is not severe.
- 7.93 Overall, LHA Officers have assessed the proposal and accept the findings and conclusions of the amended Transport Assessment and Transport Addendum in terms of network peaks, accident data, trip generations and junction capacity assessments. It is considered that the proposed development will not result in a material impact at the junctions assessed and any increase in traffic is unlikely to be discernible from daily fluctuations on the network. It is therefore concluded that the development impact is not severe. The LHA acknowledge that there are existing capacity issues at the Stocks Bridge Way Roundabout, but these are existing issues and it would not be reasonable to expect the developer to fix these issues given the minimal impact arising from the development. It is noted that a more strategic solution is required to address this issue; outside the remit of this application.
- 7.94 As a result, the LHA does not object to the proposals subject to the following mitigation:

*A 3 metre wide shared footway / cycleway being provided on the eastern side of Bluntisham Road, to start opposite the site access and connecting south to join the existing footway adjacent 96 High Street.

*A 2 metre wide footway, including 3 metre wide bus hard standing and dropped kerb crossings being provided on the western side of Bluntisham Road.

*A new bus stop being provided on the western side of Bluntisham Road to include a new shelter, raised kerbs, Real Time Passenger Information (RTPI) and maintenance contributions for the future maintenance of the shelter and RTPI system.

*The existing bus stop on the eastern side of Bluntisham Road, closest to the site being upgraded to include a new shelter, raised kerbs, RTPI system and maintenance contributions for the shelter and RTPI system.

*The developer being responsible for the provision and implementation of a Residential Welcome Packs for sustainable transport, approved by Cambridgeshire County Council, to include six months free bus travel with the relevant local public transport operator.

*The developer being responsible for the provision and implementation of a Residential Travel Plan. The Travel Plan should include the provision of a Travel Plan Co-ordinator to give advice and is to be monitored annually, with all measures reviewed to ensure targets are met.

- 7.95 These mitigation measures are considered acceptable and should be secured by conditions and through a S106 Agreement where appropriate.

Sustainability

- 7.96 With regards to sustainability, Needingworth is identified as a 'Smaller Settlement' in the Core Strategy (2009) which notes that certain services and facilities will need to be accessed in other locations. Needingworth is also identified as a 'Small Settlement' within Policy LP10 of the Huntingdonshire's Local Plan to 2036: Proposed Submission 2017 (as amended). The emerging Local Plan notes that some of the Small Settlements are more sustainable than others due to the variation in the level of services and facilities.
- 7.97 The Institute of Highways and Transportation (IHT) provide guidance on desirable walk distances in their publication 'Providing for Journeys on Foot' which recommends suggested acceptable walking distances of between 500m (6 minutes, "Desirable") and 2km (25 minutes, "Preferred Maximum") for commuting and journeys to school. For non-commuter journeys the guidance suggests that a walk distance of up to 1,200 metres can be 'considered', with the 'acceptable' and 'desirable' distances being 800 and 400 metres respectively. Similarly, acceptable cycling distances vary between individuals and circumstances but trips up to 5km (3.1miles) are accepted as having the potential to substitute car trips.
- 7.98 There are bus stops to either side of Bluntisham Road approximately 300m south of the site; approximately a 4 minute walk. The bus stops are served by Service 21 operated by Go Whippet which provides three daily services (Monday to Friday) to and from St Ives. Service

21 also provides three services per day (Monday to Friday) to and from Ramsey. Route A of the Guided Busway also serves the aforementioned bus stops, providing for limited bus journeys to and from Cambridge from Monday to Saturday. There are two services per day in each direction from Monday to Friday and one service in each direction on Saturdays.

7.99 As referred to above, as part of the proposed development new bus stops are to be provided on both sides of Bluntisham Road to include new shelters, raised kerbs and Real Time Passenger Information (along with a maintenance contribution for future upkeep).

7.100 The TA notes that the closest footway begins approximately 70m north of the proposed main access, on the eastern side of Bluntisham and connects to the centre of Needingworth. It is noted that the footway is approximately 1m in width and is of poor quality, with some sections of lighting, but overall it is poorly lit. Needingworth also benefits from an existing designated cycle route from the edge of Needingworth village to St Ives. This is accessible by turning right out of the site and routing through Needingworth to the south west exit onto the A1123 which leads to St Ives.

7.101 The table below provides a summary of distances from the application site to nearby facilities, including walking and cycling times based upon walking times of 5 kph and 14 kph respectively.

| Facility | Distance from Entrance to Development | Walking Time (in minutes – approx.) | Cycle Time (in minutes – approx.) |
|---|---------------------------------------|-------------------------------------|-----------------------------------|
| Bus stops (to either side of Bluntisham Road) | 300 metres | 4 min. | 1 min. |
| One Stop and Post Office | 850 metres | 10 min. | 2/3 min. |
| Queens Head Pub | 1.1 kilometres | 13 min. | 3 min. |
| Overcote Lane Playing Fields | 1.25 kilometres | 15 min. | 4 min. |
| Overcote Lane Village Hall | 1.25 kilometers | 15 min. | 4 min. |
| Holywell Primary School | 1.5 kilometers | 18/19 min. | 4 min. |
| Needingworth Pre-School | 1.5 kilometers | 18/19 min. | 4 min. |
| Needingworth Industrial Estate | 2.8 kilometers | 35 min | 8 min. |
| Tesco Express, St Ives | 3.3 kilometers | - | 10 min. |
| Somersham Road Industrial Estate | 3.8 kilometers | - | 12 min. |
| Parsons Green | 3.8 kilometers | - | 12 min. |
| St Ives Nursery | 3.9 kilometers | - | 12 min. |
| Eastfield Infant and Nursery School | 4.2 kilometers | - | 13 min. |
| Cromwell Place Surgery, St Ives | 4.5 kilometers | - | 14 min. |
| Westfield Junior School | 4.7 kilometers | - | 14 min. |
| St Ives Library | 4.8 kilometers | - | 15 min. |

| | | | |
|--|--------------|---|---------|
| St Ives Town Centre (includes retail outlets, banks, hair dressers, pubs, coffee shops, and fast-food outlets) | 5 kilometers | - | 15 min. |
| One Leisure St Ives, Indoor Centre | 5 kilometers | - | 15 min. |
| St Ivo Secondary School | 5 kilometers | - | 15 min. |

- 7.102 In this instance, the existing bus stop (to be improved) and new bus stop would be within 400m of the application site. Needingworth One Stop and Post Office and the Queens Head Pub are the closest amenities. It is noted that the relevant distances to services and facilities are greater than those set out in the IHT guidance and in the Huntingdonshire Design Guide Supplementary Planning Document (SPD) 2017, which refers to walking distances of 400m (5 minutes) to bus stops and 800m (10 minutes) to local shops and primary schools. However, these are not framed as absolute requirements: the SPD states that 'ideally' new homes will be built to be within those distances and the IFT guidance acknowledges that acceptable walking and cycling distances will vary between individuals
- 7.103 The level of existing facilities and services within Needingworth is greater than many of the villages identified as a 'Small Settlement' and given the location of the site adjacent to the built up area of Needingworth it is considered that occupiers would have a reasonable level of access to services and facilities within the village; either on foot or by cycle.
- 7.104 Despite the rural nature of the village of Needingworth, as highlighted within the table above, the site is well located in regards to the level of services and amenities within the village, and with regards to the accessibility of services and facilities within the nearby town of St Ives. As outlined within the IHT's guidance, it is recognised that many people will cycle to services/amenities outside of the 25-minute walk distance, but which are located within 5 kilometres (approximately a 15-minute cycle time). St Ives Market Town falls within this radius, hosting a range of retail outlets, banks, hair dressers, pubs, coffee shops, schools, nurseries, GP surgeries, dental practices and fast-food outlets. Future occupiers of the proposed development could instead opt to use bus links to St Ives to access this range of facilities and services. As a result, the site is considered well located to take advantage of existing local services, amenities and to access sustainable transport modes. It is therefore considered that the amount and location of the proposed development is sustainable when having regard to the level of service and infrastructure provision within Needingworth and when taking account of the opportunities for future occupiers of the proposed development to access everyday services and facilities by sustainable modes of travel (including walking, cycling and public transport) within the nearby Market Town of St Ives.
- 7.105 As aforementioned, off-site highways works are proposed. These include the provision of a footway/cycleway on the eastern side of

Bluntisham Road as well as a footway to the western side of Bluntisham Road. Uncontrolled crossing points formed of tactile paving are proposed to enable pedestrians to cross Bluntisham Road. A new bus stop to the western side of Bluntisham Road is proposed and improvements are proposed to the existing bus stop to the eastern side of Bluntisham Road. These measures would promote the use of sustainable modes of travel to access services and facilities within Needingworth and within the towns accessible by bus (including St Ives, Ramsey and Cambridge). In the interests of sustainability, these off-site works are considered necessary and should be secured through the imposition of conditions and through a Section 106 Agreement where appropriate.

- 7.106 A Construction Traffic Management Plan is required to ensure the construction traffic is managed and does not harm free flow of traffic during the construction phase. This can be secured by condition.

Parking:

- 7.107 Precise details will be looked at during the Reserved Matters application stage, it is however anticipated that the site can accommodate the quantum of development sought with sufficient parking provision.

Framework Travel Plan:

- 7.108 A Framework Travel Plan has been submitted alongside the application. The Framework Travel Plan sets out objectives and targets for the implementation of measures which will reduce reliance upon the use of private vehicles and encourage safe and viable alternatives for accessing the site for residents. The Framework Travel Plan includes a range of measures to encourage sustainable travel to and from the site. The FTP represents a commitment to ensure a Travel Plan Welcome Pack is adopted by the occupiers of the site. CCC as Local Highways Authority has advised that they raise no objection the proposed development subject to:

*The developer being responsible for the provision and implementation of Residential Welcome Packs for sustainable transport, approved by Cambridgeshire County Council, to include six months free bus travel with the relevant local public transport operator, and,

*The developer being responsible for the provision and implementation of a Residential Travel Plan. The Travel Plan should include the provision of a Travel Plan Co-ordinator to give advice and is to be monitored annually, with all measures reviewed to ensure targets are met.

In the interests of sustainability and as CCC have advised that their support for the scheme is provided on the basis of these mitigation measures, these should be secured by condition.

Summary:

- 7.109 Taking all the above into account, it is considered that the proposed means of accessing and circulating this site is acceptable and that the proposal complies with policies T18 and T19 of the Local Plan and LP17 and LP18 of the emerging Local Plan to 2036: Proposed Submission (as amended). As the Local Plan policies are compliant with the NPPF they can be given full weight. The emerging policies,

having regard to paragraph 216 of the NPPF, can be given significant weight.

- 7.110 Moreover, it is considered that the access details proposed are acceptable for the scale of development sought and opportunities to promote sustainable transport modes can be achieved. Therefore, it is Officer opinion that the application can be supported in highway terms, subject to a number of conditions and obligations.

Heritage Assets:

- 7.111 The application is accompanied by a Heritage Desk-Based Assessment to fulfil the requirements of paragraph 128 of the NPPF.
- 7.112 The NPPF recognises the importance of preserving heritage assets and supports sustainable development. Paragraph 7 of the NPPF confirms the three strands of sustainability. In relation to environmental matters this confirms that this includes protecting our natural, built and historic environment. Section 12 of the NPPF (paragraphs 126 to 141) sets out principles and policies for conserving and enhancing the historic environment. Paragraph 132 also advises that great weight should be given to the asset's conservation. The more important the asset, the greater the weight should be.
- 7.113 Needingworth village does not have a Conservation Area. It does however host a number of Listed Buildings. The nearest Listed Building, The Chestnuts (Grade II* Listed) is located approximately 345 metres south-west of the application site. Further Listed Buildings are also located within Needingworth village. Given the lack of historic or functional relationship and the lack of inter-visibility between the application site and the closest Listed Buildings, as a result of modern residential development between the site and these designated heritage assets, it is considered that the proposed development would not impact upon the settings of these heritage assets.
- 7.114 The closest Scheduled Monument are the eight bowl barrows, part of the Over round barrow cemetery which are located over 2.2km from the application site. Due to this significant separation distance, a lack of intervisibility, and a lack of historic or functional relationship between the application site and the nearest Scheduled Monument, it is concluded that the proposed development would not impact upon the Scheduled Monument or its setting.
- 7.115 With regards to archaeology, Cambridgeshire County Council has advised that the site is located in a landscape of high archaeological potential; situated to the north of the historic core of Needingworth. Archaeological investigations to the east at Barleycroft Farm have revealed evidence of Prehistoric settlement remains (CB15515), Bronze Age field system (CB15514) and ring ditches (CB15643) and Roman occupation evidence (11942A). Surrounding the application area is artefactual evidence of Roman occupation (for example, 00881, 03735, 03734, 03632a) and Iron Age occupation (03632). In open land to the north east (MCB23256) and south east (MCB23254) of the proposed development area is cropmark evidence of enclosures and boundaries. In addition, archaeological investigations to the south at Silver Lane revealed evidence of medieval occupation

(CB14642) and cropmark evidence of ridge and furrow (CB15347) on land adjacent to the site indicates that medieval activity extended towards the proposed development area.

- 7.116 The Archaeological Officer does not object to the proposed development subject to securing a programme of archaeological investigation. This is considered reasonable and necessary and should therefore be secured by condition.
- 7.117 Taking all the above into account, it is considered that subject to the imposition of a condition with regards to archaeology, the proposed development is acceptable with regards to the impact upon heritage assets and that the proposal complies with policies En2, En12 and En13 of the Local Plan, 1995 and policy CS1 of the Core Strategy. These policies do not allow for the balancing exercise to be undertaken, therefore the weight that can be attributed to them is slightly reduced. With regards to paragraph 216 of the NPPF, it is considered that Policy LP36 of the emerging Local Plan to 2036: Proposed Submission can be attributed significant weight.

Biodiversity:

- 7.118 Paragraph 109 of the NPPF states that 'the planning system should contribute to and enhance the natural and local environment by:
*protecting and enhancing valued landscapes, geological conservation interests and soils;
*recognising the wider benefits of ecosystem services;
*minimising impacts on biodiversity and providing net gains in biodiversity where possible.'
- 7.119 Local Plan (1995) Policy En22 requires appropriate account be taken of nature and wildlife conservation and policy LP32 of the emerging Local Plan to 2036: Proposed Submission aims to conserve and enhance biodiversity and advises that opportunities should be taken to achieve beneficial measures within the design and layout of development and that existing features of biodiversity value should be maintained and enhanced.
- 7.120 The application is supported by an Ecological Impact Assessment undertaken by CSA Environmental dated November 2017. During the application, additional and amended ecological information was submitted in response to comments received from Consultees.
- 7.121 Ecological Designations - the site itself is not subject to any statutory or non-statutory nature conservation designations. There are three internationally important statutory designations Ouse Washes SPA, SAC and Ramsar, all approximately 4.5km northeast of the Site. A single local statutory designation is present within 3km of the application site: Mare Fen LNR (approximately 2.9km to the south-east of the Site). With regards to non-statutory designations, the River Great Ouse County Wildlife Site (CWS) is located approximately 1.8km east of the Site). Ouse Fen RSPB Reserve is located approximately 20m east of the site.
- 7.122 The Ecological Impact Assessment acknowledges that the proposed development has the potential to increase visitor numbers to the Ouse Washes. The Ouse Washes benefit from purpose built visitor

centres and footpaths. Given the scale of the development and distance (4.5km) between the site and the Ouse Washes, it is anticipated that any increase in footfall to this designated site would be limited. In addition, any increase in recreational pressures would likely be limited to a small portion of the washes, around the visitor centre and along footpaths, which are designed for visitors. The proposal is not therefore anticipated to result in significant adverse effects to the Ouse Washes SPA, SAC, or Ramsar.

- 7.123 The proposal has the potential to increase recreational pressure on Mare Fen LNR, although any increase in footfall is anticipated to be limited, given the scale of development. The application site will also host public open space, limiting any increase in recreational pressure on Mare Fen LNR. It is noted that Mare Fen LNR is managed for the benefit of wildlife and public amenity, and as such, any resultant increase from the development is not anticipated to result in significant adverse effects to the LNR.
- 7.124 The development of the site has the potential to impact upon the River Great Ouse CWS through potentially impacting water quality. The submitted Ecological Impact Assessment sets out that the development would include appropriate surface water drainage arrangement to ensure the development would not result in adverse impacts on water quality. A scheme for surface water drainage will be secured by condition.
- 7.125 Ouse Fen RSPB Reserve is located within walking distance of the application site; being located approximately 20m east of the site. It is therefore noted that the proposed development would place increased recreational pressure on the reserve. Within the submitted Ecological Impact Assessment it is outlined that discussions have taken place with the RSPB and it is highlighted that the principal concern with regard to the impact on Ouse Fen Reserve relates to social pressures, most notably increased dog walking, rather than threats to specific bird species. Therefore, the Assessment proposes appropriate mitigation to be the provision of a bin for dog waste (to be installed and managed) within the Reserve Car Park and bins for dog waste within the application site as part of the development. These measures could be secured through the imposition of a Grampian condition given the Reserve owners agreement and a further condition with regards to the provision of bins on site.
- 7.126 Overall, it is concluded that subject to the provision of bins for dog waste within the car park of the Ouse Fen RSPB reserve and within the application site, these ecological designations are unlikely to be adversely affected by the proposed development.
- 7.127 Habitats - The site consists of a variety of habitats including: poor semi-improved grassland, hedgerows, tall ruderal vegetation, broad leaved plantation woodland, dense scrub, remnant orchard, amenity grassland, numerous buildings, hardstanding/bare ground and a dry ditch (bounding the site to the north). Of these habitats, it is identified that the hedgerows at the site are of ecological importance significant at the Local level and the remnant orchard is also considered to be of ecological importance, significant at the Local level, primarily in respect of its resource for invertebrates and other associated fauna.

The other habitats are all identified to fall below the threshold of ecological significance.

- 7.128 The mature trees and hedgerows that bound the site and run across the centre of the site provide opportunities for a range of wildlife and measures and recommendations are set out in order to safeguard and enhance these features. A replacement orchard is also proposed to mitigate the loss of the remnant orchard.
- 7.129 Flora - It is noted that there are 28 records of 15 notable plant species from within the search area. Those of potential relevance to the site include annual knawell and green-winged orchid. These species were not seen during the Phase 1 survey or during any of the subsequent surveys undertaken. As such, it is not considered that the proposed development would have an adverse impact upon important flora.
- 7.130 Fauna - Presence and absence surveys in relation to Great Crested Newts were undertaken due to the potential habitat provided by a nearby pond. The surveys confirmed the absence of Great Crested Newts. The surveys undertaken also identify the presence of reptiles (grass snakes) and bats (long brown eared bats roosting within an existing building on the site),
- 7.131 Birds, nesting birds and invertebrates were all noted within the site as part of the preliminary ecological assessment.
- 7.132 Whilst not identified as being present, the Ecological Impact Assessment identifies that that the habitats within the site also provide potential opportunities to support badgers and hedgehogs.
- 7.133 Accordingly, a number of recommendations and measures are set out in regard to faunal species in order to ensure that they are safeguarded under the proposals. The imposition of these could be secured by condition. It is noted that due to potential impact upon bats, it is necessary for an EPS licence to be sought from Natural England. A note can be added to any consent granted to make the applicant aware of this requirement.
- 7.134 Enhancements - A number of enhancements for the benefit of biodiversity are available under the proposals with a range of recommendations, including the provision of plant species of known wildlife value within the planting scheme, a community orchard to replace the remnant orchard, bird boxes, bat boxes and the inclusion of holes within timber fencing to facilitate hedgehog movements, to maximise opportunities for wildlife at the site.
- 7.135 The Wildlife Trust has confirmed they agree with the ecological assessment provided and conclude that the current ecological interest of the site is not likely to be significantly impacted by the proposals. Subject to necessary conditions, the proposal is therefore considered to comply with the NPPF and local policies; given the broad consistency of these policies with the NPPF, En22 can be given full weight and LP32 significant weight, in taking account of paragraphs 215 and 216 of the NPPF.

Flooding, Drainage, Ground Conditions And Contamination:

- 7.136 The overall approach to flooding is given in paragraphs 100-104 of the NPPF and these paragraphs set out a sequential, risk-based approach to the location of development. This approach is intended to ensure that areas at little or no risk of flooding are developed in preference to areas at higher risk. It involves applying a Sequential Test to steer development away from medium and high flood risk areas (FZ2 and FZ3 land respectively), to land with a low probability of flooding (FZ1).
- 7.137 The vast majority of the application site falls within FZ1 as designated within the Strategic Flood Risk Assessment 2017, which represents the lowest flood risk of flooding from rivers and sea. A very small portion of the site (approximately 0.1 hectares) falls within FZ3a. The site is not located within a Groundwater Source Protection Zone (SPZ). Notwithstanding this, given the scale of development proposed, the application is supported by a site specific Flood Risk Assessment (FRA).
- 7.138 Given only a small portion of the site within FZ3a it is considered that the quantum of development could be achieved on land designated as FZ1.
- 7.139 CCC as the Lead Local Flood Authority (LLFA) has commented on the application and raises no objection in principle to the proposed development. The LLFA note that the applicant has demonstrated that surface water can be dealt with on site using swales and an infiltration pond, to adequately control the rate of flow into a nearby ditch. The LLFA acknowledge that surface water flood risk is medium or high in parts of the site; however, they advise that SuDS features could be positioned in these locations to provide storage and controlled conveyance (this is shown on the indicative Development Framework Plan). Consequently, conditions are recommended by the LLFA to secure details of the surface water drainage scheme (including the use of sustainable drainage systems (SuDS) and longterm maintenance arrangements. These are considered acceptable and meet the statutory tests. The ditch to which the surface water from the site will drain is under the authority of the Bluntisham Internal Drainage Board (IDB); managed by the Middle Level Commissioners (MLC). The MLC on behalf of Bluntisham IDB have not raised any objection to the application but have requested that an informative is appended to any permission granted to provide notification of their requirements.
- 7.140 The Environment Agency has reviewed the information provided and has advised that they have no comment to make on the application.
- 7.141 Anglian Water (AW) has commented on the application raising no objections to the scheme, advising that there are no AW assets within the development area. AW also advises that there is capacity at their Needingworth Water Recycling Centre for foul drainage and capacity within the foul sewerage network. AW has also advised that having reviewed the submitted Foul Drainage Analysis (by Utility Law Solutions dated July 2017), they are satisfied with the foul drainage strategy detailed. AW has advised that no conditions are required with regards to foul drainage arrangements as this will be dealt with under separate legislation through Building Regulations.

- 7.142 AW also note that the current surface water drainage arrangements do not relate to AW operated assets, however they have advised that should the development rely on AW systems for surface water disposal, further discussion should take place to ensure the most appropriate scheme is designed. The condition recommended by the LLFA to secure details of the surface water drainage scheme (including the use of sustainable drainage systems (SuDS) will ensure that clarity with regards to proposed surface water drainage arrangements is provided and that adequate provision is made for the drainage of surface water.
- 7.143 It is therefore considered that subject to conditions, the development can be made acceptable in flood risk terms.
- 7.144 Third party comments have been received that despite the formal flood designation, the site does flood and concerns have been raised that development of the site would exacerbate this. It has also been highlighted that insufficient detail has been provided with regards to drainage. These comments are noted and details of surface water run-off would be secured through condition. Third party comments have also raised concerns with regards to sewage capacity. These comments are noted, however as set out above, Anglian Water has advised that there is capacity within the foul sewerage network to accommodate needs arising from the development.

Other Matters:

Infrastructure -

- 7.145 Concerns have been expressed that local doctors surgeries, dentists and schools (Holywell Primary School and St Ivo Secondary School) cannot cope with the additional development proposed. As this application is a small-scale major development for less than 200 dwellings, S106 contributions for education and health cannot be sought as these should be funded through the Community Infrastructure Levy. Notwithstanding this, advice has been sought from Cambridgeshire County Council Education to establish whether there are capacity issues and how this may impact upon the wider sustainability considerations of the scheme.
- 7.146 In terms of education provision, Cambridgeshire County Council has advised that Holywell C of E Primary School has a Planned Admission Number (PAN) of 30 (30 new entrants each year school) and a total school capacity of 210 places (30 pupil intake x 7 years). The school had 202 pupils on roll in September 2017 so is close to full capacity. However, based on catchment forecasts, the school is forecast to have sufficient capacity in the future if out-catchment options are excluded. With regards to Secondary education, CCC has advised that St Ivo has a PAN of 300 and a total 11-15 capacity of 1500 places. There were 1423 pupils on roll in September 2017. CCC note that although there may be a need to expand the school in the long term, given the continuing growth in St Ives, the catchment forecasts do not show a pressing need for this in the short to medium term.

Parish Comments -

- 7.147 It is noted that within their representation the Parish Council has set out a list of improvements and recommendations which it considers should be included within a Section 106 Agreement if the application were recommended for approval. These are considered in turn:
- 7.148 - Roundabout at junction of Bluntisham Road and A1123/ Turn left only out of new site entrances to prevent excess traffic via High Street which was removed by the bypass.
The Local Highways Authority has reviewed the supporting information submitted as part of the application and has concluded that the access arrangements proposed and impact upon the local highways network is acceptable, subject to the matters to be secured by condition and through a Section 106 agreement as aforementioned within this report. Provision of a roundabout as requested is not necessary to make the development acceptable in planning terms. The implementation of a restriction with regards to the flow of traffic exiting the site is not necessary to make the development acceptable in planning terms.
- 7.149 - Sufficient money to employ staff and maintain public areas for minimum of 10 years.
Financial contributions for the maintenance of Green Space would be secured through the associated Section 106 Agreement, in accordance with the rates set out within the Developers Contribution SPD for a period of 15 years.
- 7.150 - Contribution to allow improvements to village hall which is the only public building in the village.
This is not necessary to make the development acceptable in planning terms. The development would be CIL liable. Any CIL receipts would be spent in accordance with the CIL Regulations and cannot be solely for the Holywell-cum-Needingworth area. Notwithstanding this, it should be noted that the Parish Council will receive a meaningful proportion of the CIL receipts in accordance with the Regulations and this should fund:
1. The provision, improvement, replacement, operation or maintenance of infrastructure; or
2. Anything else that is concerned with addressing the demands that development places on an area.
It is therefore advised that a certain amount of CIL receipts will be used by the Parish Council to address local needs.
- 7.151 - New community allotment land
The precise details for on-site open space would be established through the S106 agreement and reserved matters details. This may include allotments subject to demand.
- 7.152 - New burial ground.
The provision of a new burial ground is not necessary to make the development acceptable in planning terms; therefore it is not reasonable to require the proposed development to provide this.
- 7.153 - Subsidy to provide daily bus service to St Ives at regular intervals throughout the day.
For the reasons given above in the highways section of this report a bus subsidy is not necessary to make the development acceptable in planning terms.

- 7.154 - New bus stop (Near development)
The LHA has advised that a new bus stop to the western side of Bluntisham Road and the upgrading of the existing bus stop to the eastern side of Bluntisham Road is required to make the development acceptable. The provision of these would be secured by condition.
- 7.155 - Improvements to footpath into village.
The LHA has advised that improvements to the footpath into the village are required. These are shown on the 'Proposed Footway Widening' Plan (Drawing 12 Rev. C). The implementation of these improvements, prior to the occupation of the development, would be secured by condition.
- 7.156 - Improved street lighting along footpath.
The submission of details relating to the improvement works required to footpaths to the eastern and western sides of Bluntisham Road would be secured by condition, as recommended by the LHA. These details should include details of proposed lighting.
- 7.157 - 30pmh speed limit to be moved to take in development
Drawing 12.3 Rev. A demonstrates that based on the findings of the speed survey undertaken, adequate visibility splays can be achieved without a reduction to the speed limit along Bluntisham Road. The LHA have confirmed that the visibility splays shown are acceptable. A reduction to the speed limit along Bluntisham Road is not therefore necessary to make the development acceptable in planning terms.
- 7.158 - Shop
This is not necessary to make the development acceptable in planning terms. It is noted that provision of a shop would likely threaten the viability of the existing shop within the village.
- 7.159 - Doctors
As referred to above, this application is a small-scale major development for less than 200 dwellings, S106 contributions for health cannot be sought as these could be funded through the Community Infrastructure Levy.
- 7.160 - Review of village school's capability to deliver an education to the children based on ability to absorb the intake. It may require an extension to the school.
As set out above, CCC as the Local Education Authority have advised that the primary school is close to full capacity, however, the school is forecast to have sufficient capacity in the future if out-catchment options are excluded. As this application is a small-scale major development for less than 200 dwellings, S106 contributions for education cannot be sought as these could be funded through the Community Infrastructure Levy.
- 7.161 - Noise and dust suppression by limiting the hours of working to Monday to Friday 9am to 17.00 and Saturday 9am to Noon. No work on Sundays.
These concerns are noted. The restriction of construction hours to reduce the noise impact for neighbours will be secured with the Construction Environmental Management Plan.

- 7.162 Fire Hydrants -
Cambridgeshire Fire and Rescue Service require the provision of fire hydrants be secured through an appropriately worded planning condition; this is considered acceptable.
- 7.163 Environment Impact Assessment (EIA) -
In accordance with the EIA Regulations 2017 the proposal has been screened. The proposed development is not EIA development.

Infrastructure Requirements And Planning Obligations:

- 7.164 The Infrastructure Business Plan 2013/2014 (2013) was developed by the Growth and Infrastructure Group of the Huntingdonshire Local Strategic Partnership. It helps to identify the infrastructure needs arising from development proposed to 2036 through the Core Strategy.
- 7.165 Statutory tests set out in the Community Infrastructure Regulations 2010 (Regulation 122) require that S.106 planning obligations must be necessary to make the development acceptable in planning terms, directly related to the development and fairly and reasonable related in scale and kind to the development. S.106 obligations are intended to make development acceptable which would otherwise be unacceptable in planning terms.
- 7.166 Without prejudice to the eventual determination of the planning application, negotiations have been held with the applicants in order to determine the extent of the obligations required to make the development acceptable. These negotiations have been held in line with the advice within the Regulations and the outcome is summarised below. Other relevant matters will be addressed via specific planning conditions.
- 7.167 The Planning Obligations SPD sets out within Part 2 that in determining infrastructure needs, the Council and partners have had to translate dwelling numbers into population generation. This has been undertaken utilising the anticipated change in average household sizes. For the purposes of calculating the likely infrastructure requirements, the 2016 average household size has been used (2.25 people per household). With the development description stating up to 120 dwellings this equates to (120 x 2.25) 270 people.

Community Infrastructure Levy (CIL):

- 7.168 As this application site is for a small-scale major development (under 200 dwellings) the development will be CIL liable in accordance with the Council's adopted charging schedule; CIL payments could cover infrastructure relating to footpath and access, health, community facilities, libraries and lifelong learning, and education.

Affordable Housing:

- 7.169 The site is over 0.5 hectares in size and Core Strategy Policy CS4, the Developer Contributions SPD (part A) and Draft Local Plan 2036

policy LP25 seek to achieve a target of 40% affordable housing on sites of this size. With the proposed number of dwellings up to 120 this would equate to a maximum total of 48 units. The policies indicate that provision should be made on site and should seek to achieve a target tenure split of 70% social rented and 30% shared ownership. Policy does however acknowledge that, in determining the amount and mix of affordable housing to be delivered, site specific considerations and other material considerations, including viability, will be taken into account.

- 7.170 In this instance no site specific considerations have been submitted and therefore the proposal shall provide policy compliant affordable housing provision.

Residential Wheeled Bins:

- 7.171 Each dwelling will require the provision of one black, blue and green-wheeled bin. The current cost of such provision is £73.65 per dwelling. For flats within the development, communal 1100 litre bins could be provided rather than individual bins for each dwelling. The current cost for communal bins in is £669.00 per communal bin. As such a formula based approach is suggested with the scheme and details to be secured through the S106 Agreement.

Planning Balance & Conclusion:

- 7.172 This proposal would result in development outside of the built-up area of the settlement and would conflict with policies H23, En17 of the HLP and CS3 of the CS. Para. 215 of the NPPF is clear that the Framework can override Development Plan policies which are not consistent with provisions of the NPPF and this is a material consideration in the determination of the application. Given the inconsistencies of the adopted housing supply policies with the NPPF, the 'tilted balance' set out in para. 14 of the NPPF is engaged and shifts the planning balance in favour of the grant of consent, unless any adverse impacts of doing so would significantly and demonstrably outweigh the benefits.
- 7.173 The presumption in favour of sustainable development requires proposals to achieve economic, social and environmental gains; as such a balancing exercise has to be undertaken to weigh the benefits of the scheme against its disadvantages.
- 7.174 In terms of the economic dimension of sustainable development, the proposal would contribute towards economic growth, including job creation - during the construction phase and in the longer term through the additional population assisting the local economy through spending on local services/facilities. There will also be Council Tax receipts arising from the development. The loss of this relatively small parcel of agricultural land and the existing poultry farm may result in a slight loss to the economy, however in the context of the District, this is considered to be low. The loss of agricultural land and the existing employment use is outweighed by the positive economic benefits of this development, in this location.
- 7.175 Regarding the social dimension, the site appears to have no significant constraints and is deliverable. It would also increase the

supply of housing, including a policy compliant provision of affordable housing at 40%; this should be afforded significant weight. There is a local identified need for both private and affordable housing and whilst the weight this need can be given is lessened given the NPPF compliant supply of housing, there would be a net benefit in social terms. Whilst the Council can demonstrate a 5 year supply of deliverable housing land, the provision of market housing on the application site would amount to a benefit in terms of providing a greater flexibility to the supply of housing.

- 7.176 In terms of the environmental dimension of sustainable development, the proposal offers potential for the incorporation of energy efficiency measures (to be considered in detail at reserved matters stage) as well as additional planting and habitat enhancement through Sustainable Urban Drainage features and the incorporation of bat and bird boxes which weigh in its favour. The proposal would result in the permanent loss of BMV land but this loss is not considered to be significant. The visual impacts of the development are considered to be acceptable given the limited harm arising from the development and the net benefits arising from the additional landscaping. The impacts from adjacent road noise would be made satisfactory for new residents. It is therefore considered that there will be a net benefit in environmental terms. The application site constitutes a sustainable location for the scale of development proposed in respect of access to local employment opportunities, services and facilities within the village of Needingworth and within the nearby market town of St Ives; accessible by sustainable transport mode. This is a further factor in support of the proposal.
- 7.177 Having fully assessed all three dimensions of sustainable development; economic, social and environmental within this report it is concluded that the development of this site will:
- provide a supply of affordable and market housing to meet current and future generations;
 - promote healthy, active lifestyle through green space provision;
 - maximise opportunities for use of public transport, walking and cycling;
 - minimise pollution;
 - manage flood risk and drainage effectively;
 - have less than substantial harm on archaeological interest which is outweighed by the community benefits, particularly the provision of affordable housing;
 - have no significant adverse impacts on features of landscape or ecological value;
 - provide appropriate infrastructure to meet the needs generated by the development.
- 7.178 It is accepted that the proposed development would result in some harm as the proposal would not accord with development plan policies that seek to restrict development in the countryside. It is also noted that there is local opposition to the proposal.
- 7.179 However when considered in the round, the proposal would contribute significantly to the economic and social dimensions of sustainability. The scheme offers some environmental benefits but there would also be moderate harm to the character and appearance

of the area. Overall, the harm identified is not considered to significantly and demonstrably outweigh the scheme's benefits when assessed against the policies in the NPPF taken as a whole. This is a significant material consideration which outweighs the conflict with the Development Plan and therefore it is recommended that permission should be granted.

8. **RECOMMENDATION** - **APPROVAL** subject to the prior completion of a Section 106 obligation relating to affordable housing, provision of open space and maintenance contribution, wheeled bins, maintenance contributions for bus shelters and Real Time Passenger Information system, and subject to conditions to include those listed below.

OR

8. **RECOMMENDATION** - **REFUSAL** in the event that the obligation referred to above has not been completed and the applicant is unwilling to agree to an extended period for determination, or on the grounds that the applicant is unwilling to complete the obligation necessary to make the development acceptable.

CONDITIONS

- Timing of permission and submission of Reserved Matters
- Scale parameters - maximum of 120 dwellings
- Finished floor levels
- Affordable housing provision at 40%
- Surface water drainage scheme
- Details of maintenance arrangements for the surface water drainage scheme
- Provision of a shared footway/cycleway on the eastern side of Bluntisham Road.
- Provision of a footway including bus hard standing and dropped kerb crossings on the western side of Bluntisham Road.
- Provision of a new bus stop on the western side of Bluntisham Road and upgrading of the existing bus stop on the eastern side of Bluntisham Road (to include provision of Real Time Passenger Information system to comply with LHA specification).
- Provision and implementation of a Residential Welcome Pack for sustainable transport
- Provision and implementation of a Residential Travel Plan
- Access width and radii
- Visibility Splays
- Road adoption details, construction specification, and maintenance and management arrangements
- Archaeological investigation
- Fire Hydrants
- Contamination Site Investigation and Remediation Strategy
- Ecological Mitigation and Enhancement
- Acoustic Mitigation Scheme as part of reserved matter applications
- Arboricultural Method Statement

- Construction Environment Management Plan (to include details of dust mitigation, wheel wash facilities, temporary parking/turning/unloading arrangements during construction, routes for traffic associated with construction and construction hours)
- Provision and management of bins for dog waste

If you would like a translation of this document, a large text version or an audio version, please contact us on 01480 388388 and we will try to accommodate your needs.

CONTACT OFFICER:

Enquiries about this report to **Laura Nuttall Senior Development Management Officer 01480 388331**

Huntingdonshire DC Public Access

From: developmentcontrol@huntingdonshire.gov.uk
Sent: 19 September 2017 12:25
To: DevelopmentControl
Subject: Comments for Planning Application 17/01687/OUT

Planning Application comments have been made. A summary of the comments is provided below.

Comments were submitted at 12:24 PM on 19 Sep 2017 from Miss Jane Bowd - Needingworth PC.

Application Summary

Address: Land South Of The A1123 And West Of Bluntisham Road
Needingworth

Proposal: Outline planning application for the demolition of the bungalow, six poultry sheds and other outbuildings and the erection of up to 120 dwellings with public open space, landscaping and sustainable drainage system (SuDS) and vehicular access points from Bluntisham Road. All matters reserved except for means of access

Case Officer: Laura Nuttall

[Click for further information](#)

Customer Details

Name: Miss Jane Bowd - Needingworth PC
Email: needingworthpc@btconnect.com
Address: Village Hall Overcote Lane, Needingworth,
Cambridgeshire PE27 4TU

Comments Details

Commenter Type: Town or Parish Council

Stance: Customer objects to the Planning Application

Reasons for comment:

Comments: Following a Public open meeting attended by 70 residents The Parish Council unanimously objected to this application at an Extra Ordinary meeting on 18th September 2017 for the following reasons:
LP7 - Smaller settlements.
Needingworth has been identified by HDC as a smaller settlement in both the current and emerging Local Plan based on its inability to sustain large scale development such as that proposed in this application.
Council does not consider that this site is located within the built up area of the current village.
No mention is made in the application of it being a rural exemption site and therefore cannot be supported via other policies.
The current infrastructure cannot support a development of this size and scale.

The village is served by a local convenience store, a primary school and a public house. The bus service is to be subsidised for 12 months by CCC but is then being removed so there is no alternative but to access other facilities such as medical services/clothing retailers/supermarkets/recreation facilities than by using a car to travel to the nearest town.

The local housing need as identified in the housing need survey is to be met by a planning application which is currently pending decision by the local authority.

At the current time the village primary school has very limited scope to accept more pupils.

The local secondary school St Ivo in St Ives is at capacity.

LP8- The Countryside.

The site is currently used for agricultural purposes and developing the site would therefore result in an irreversible loss of good quality agricultural land.

The site is directly opposite an RSPB nature reserve and noise, odour, obtrusive light or other impacts would adversely affect the use and enjoyment of the countryside by others.

As with many areas in the County this land is known to have high water table and the application identifies need for substantial drainage scheme. Drainage of the site would have dramatic impact on the intrinsic character of the area.

LP27 Community Planning proposal.

Council do not consider this site is well related to the built up area.

The site is located next to the junction with the A1123 which is an accident black spot.

The footpath to the proposed site is on the opposite side of the road and is not of a good standard neither is it adequately lit. As such this further segregates the site from the centre of the village.

The local need as identified is to be met by a rural exemption site development.

Five Year Land Supply:

The Parish Council is aware that Huntingdonshire District Council (HDC) has an obligation to demonstrate an up to date five year supply of deliverable housing sites under the conditions imposed by the NPPF. From HDC's Annual Monitoring Report published in December 2016 this is currently set at 5.24 years and incorporates a 5% buffer applied to both the requirement and the shortfall on delivery from 2011 - 2016. Since 2006 HDC have exceeded the housing requirement in six of the last ten years and predicted completions over the next five years indicate that the achievable supply is more than sufficient to both meet the current requirement and make up any previous shortfall. To further bolster this claim HDC have carried out an interim review of its land supply and now include a buffer of 20% with a five year supply of deliverable housing sites of 5.31 years.

Therefore as HDC can fully demonstrate a five year supply of housing land and its current policies are fully up to date there is no reason why this site should be given approval.

Scale and Appearance: HDC Local Plan policies En25, HL5 and LP5 seek to ensure that development respects and enhances its local setting and responds and improves the character of the local built environment. Design is also identified as a core principal of sustainable development in the NPPF. The Council consider that this application fails to meet the requirements of all of these policies for reasons already stated.

In spite of the reasons for the Parish Council objections above if HDC is mindful to recommend approval or if the proposal is subsequently subject to a planning appeal against its refusal the PC would wish the following to be included as minimum Section 106 requirement:

- Roundabout at junction of Bluntisham Road and A1123
- Turn left only out of new site entrances to prevent excess traffic via High Street which was removed by the bypass.
- Sufficient money to employ staff and maintain public areas for minimum of 10 years.
- Contribution to allow improvements to village hall which is the only public building in the village.
- New community allotment land
- New burial ground.
- Subsidy to provide daily bus service to St Ives at regular intervals throughout the day.
- New bus stop.(Near development)
- Improvements to footpath into village.
- Improved street lighting along footpath.
- 30pmh speed limit to be moved to take in development.
- Shop
- Doctors
- Village hall expansion/improvements to accommodate additional resident's requirements.
- Review of village school's capability to deliver an education to the children based on ability to absorb the intake. It may require an extension to the school.
- Noise and dust suppression by limiting the hours of working to Monday to Friday 9am to 17.00 and Saturday 9am to Noon. No work on Sundays.

Huntingdonshire DC Public Access

From: developmentcontrol@huntingdonshire.gov.uk
Sent: 07 February 2018 07:25
To: DevelopmentControl
Subject: Comments for Planning Application 17/01687/OUT

Planning Application comments have been made. A summary of the comments is provided below.

Comments were submitted at 7:25 AM on 07 Feb 2018 from Miss Jane Bowd - Needingworth PC.

Application Summary

Address: Land South Of The A1123 And West Of Bluntisham Road
Needingworth

Proposal: Outline planning application for the demolition of the bungalow, six poultry sheds and other outbuildings and the erection of up to 120 dwellings with public open space, landscaping and sustainable drainage system (SuDS) and a vehicular access point from Bluntisham Road. All matters reserved except for means of access. (AMENDMENT TO APPLICATION DESCRIPTION. ADDITIONAL AND AMENDED DOCUMENTS AND PLANS RECEIVED. OBSERVATIONS TO BE MADE BY 14TH FEBRUARY 2018).

Case Officer: Laura Nuttall

[Click for further information](#)

Customer Details

Name: Miss Jane Bowd - Needingworth PC
Email: needingworthpc@btconnect.com
Address: Village Hall Overcote Lane, Needingworth,
Cambridgeshire PE27 4TU

Comments Details

Commenter Type: Town or Parish Council
Stance: Customer objects to the Planning Application
Reasons for comment:
Comments: Ref amendments.
The Parish Council have considered the amendments to the original plans and also the additional resident comments.
Council consider that the amendments have not addressed any of their original concerns and therefore the original comments objecting to the proposed development dated 20/9/17 still stand.

Development Management Committee



Scale =1:5,000

Date Created: 09/05/2018

Application Ref: 17/01687/OUT

Location: Needingworth

© Crown copyright and database rights 2018
Ordnance Survey HDC 10002322

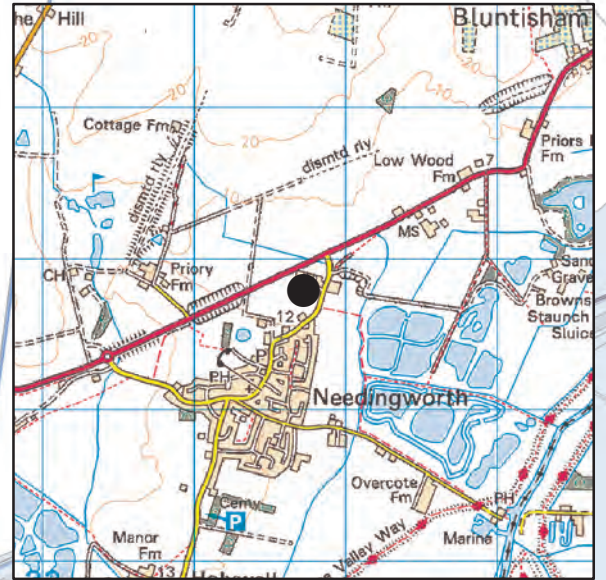
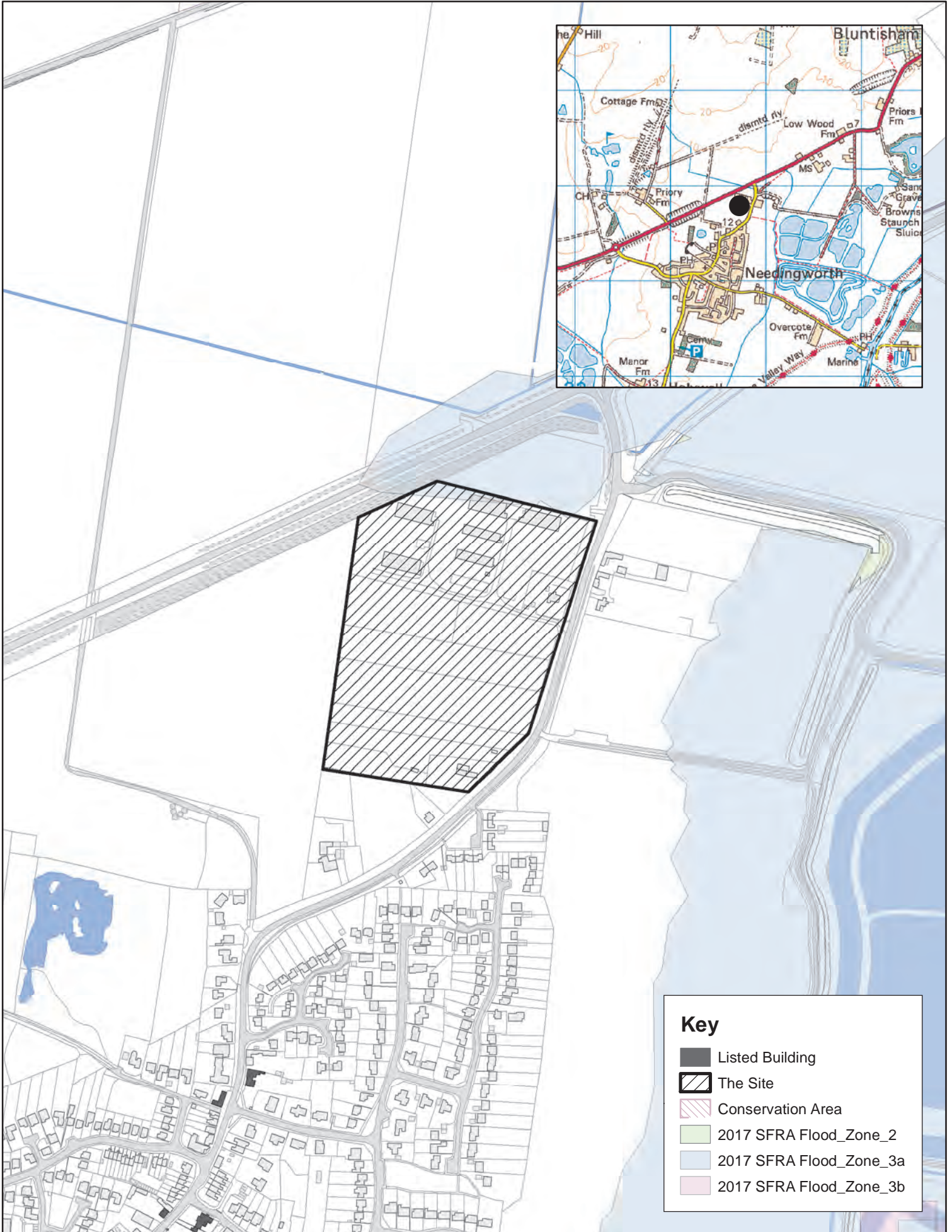

Key

- Listed Building
- The Site
- Conservation Area
- 2017 SFRA Flood_Zone_2
- 2017 SFRA Flood_Zone_3a
- 2017 SFRA Flood_Zone_3b

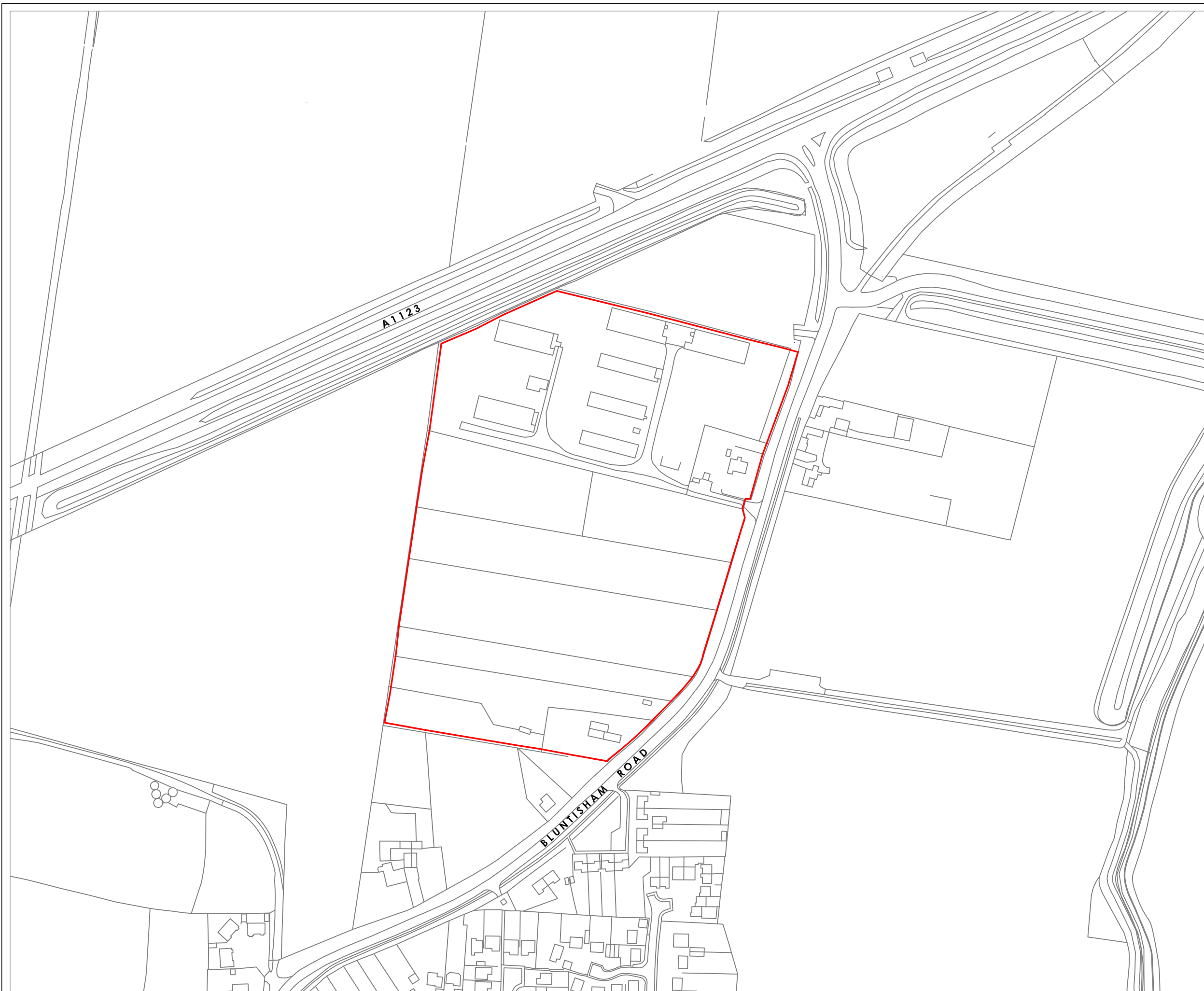

0 50 100 metres









Site boundary: **6.44ha**

Based upon the Ordnance Survey map with the permission of the Controller of Her Majesty's Stationary Officer, Crown Copyright reserved.
Licence Number AR 100031731

| Rev | Date | By | Description |
|---|--|----------------|-------------|
|  Dixies Barns, High Street, Ashwell, Hertfordshire SG7 5NT t 01462 743647 e ashwell@csaenvironmental.co.uk w csaenvironmental.co.uk | | | |
| Project | Land off Bluntisham Road, Needingworth | | |
| Title | Site Location Plan | | |
| Client | Gladman Developments Ltd | | |
| Scale | 1:2500 @ A3 | Drawn | AS |
| Date | 19.07.2017 | Checked | CA |
| Drawing No. | CSA/3272/111 | Rev | - |

-  Site Boundary: **6.44ha**
-  Proposed residential area: **3.7ha**
(Up to 120 dwellings @ 32 dph)
-  Proposed informal and amenity green space

Movement & Infrastructure

-  Proposed vehicular access point
-  Proposed spine street through development
-  Proposed secondary streets and lanes/private drives
-  Proposed recreational route
-  Proposed cycle route
-  Proposed new pedestrian and cycle links
-  Existing public rights of way
-  Key spaces with priority for pedestrian movements

Green Infrastructure & Recreation

-  Existing vegetation
-  Existing vegetation to be removed
-  Proposed location for children's play area
-  Proposed locations for SuDS features
-  Proposed tree and hedgerow planting
-  Proposed orchard



Proposed new boundary landscaping to filter views of the development from the A1123

Sustainable Drainage Features (SuDS)

Children's play area

Road crossing points designed for pedestrian priority

Proposed vehicular access point

Tactile paving at crossing area

Footway widened to 3m to accommodate bus stop for northbound services

Footway along eastern side of Bluntisham Road to be widened to 3m

Proposed new recreational route through development

Tactile paving at crossing area

Proposed orchard and wildflower grass to compensate for the loss of the existing low quality trees and hedgerows

Full Planning application for 14 new homes on land adjacent to Fair View, Bluntisham Road, Needingworth - decision: pending

Footway to tie into existing

| | | | |
|-----|----------|-----|--------------------------------------|
| G | 01/02/18 | SM | Amendments to pedestrian routes |
| F | 05/10/17 | SM | Amended to reflect client's comments |
| E | 24/07/17 | AgB | Tree survey added |
| D | 19/07/17 | AS | Site boundary amended |
| Rev | Date | By | Description |



Dixies Barns, High Street,
Ashwell, Hertfordshire SG7 5NT
01462 743647
ashwell@csaenvironmental.co.uk
csaenvironmental.co.uk

| | | | |
|-------------|--|---------|-----|
| Project | Land off Bluntisham Road, Needingworth | | |
| Title | Development Framework Plan | | |
| Client | Gladman Developments Ltd | | |
| Scale | 1:2000 @ A3 | Drawn | AgB |
| Date | June 2017 | Checked | SG |
| Drawing No. | CSA/3272/105 | Rev | G |



Figure 5.2: Illustrative Masterplan

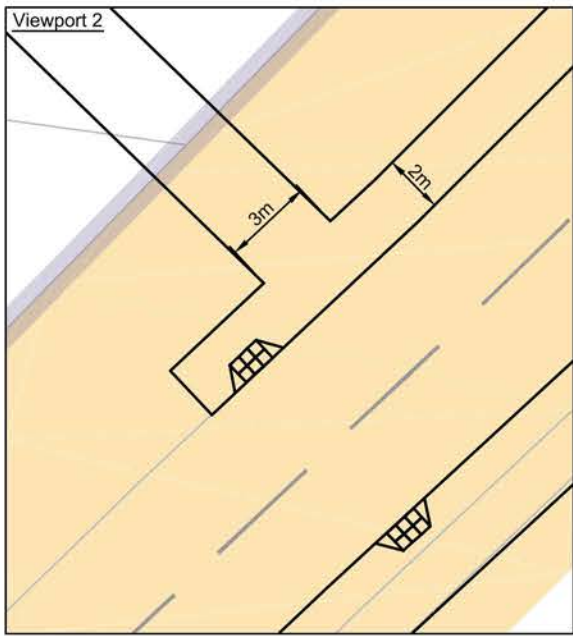
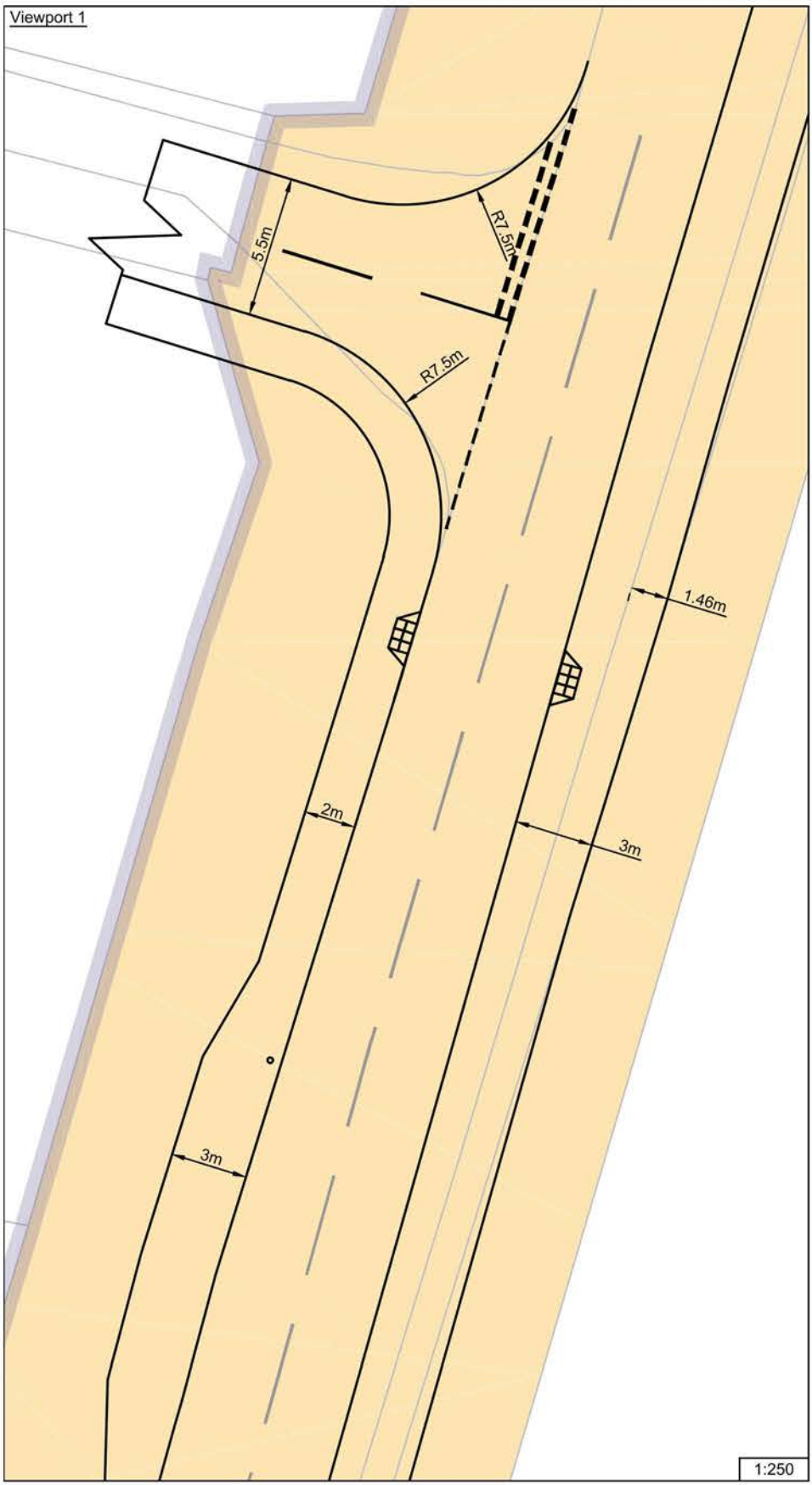

Key;

- Footway Extension
- Highway Boundary
- Site Boundary

Highway Boundary transcribed from 'OS' Base mapping supplied by Cambridgeshire County Council. Icen Projects Ltd. are not responsible for it's accuracy and advise that boundary is verified by solicitors.

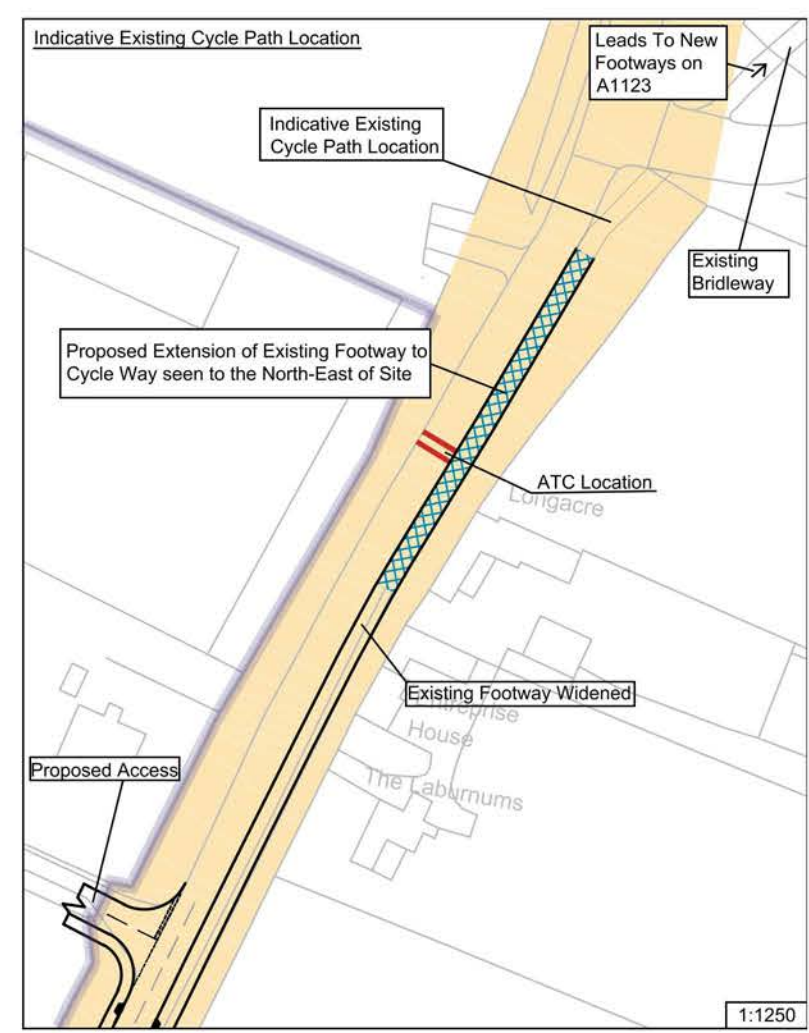
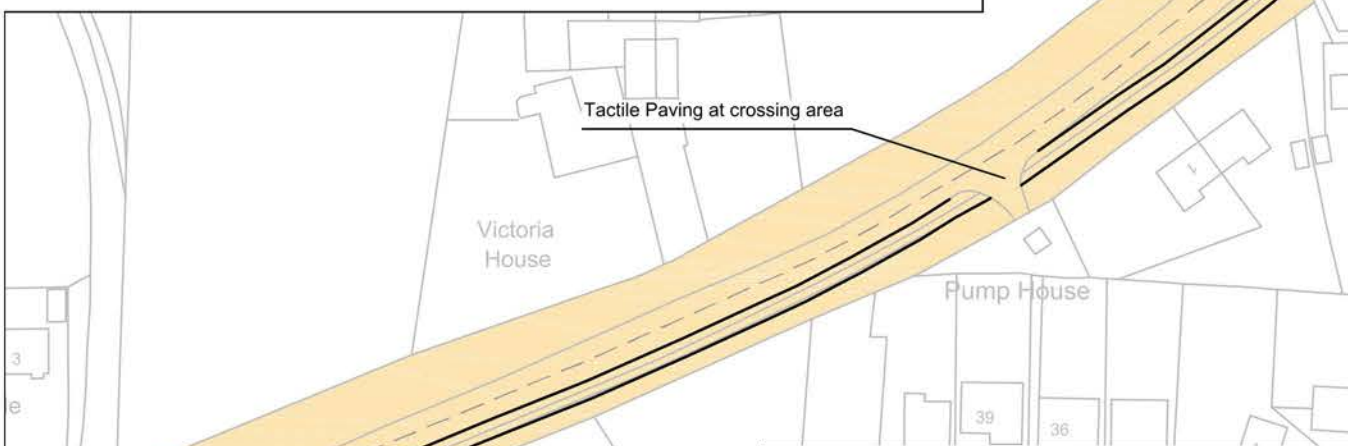
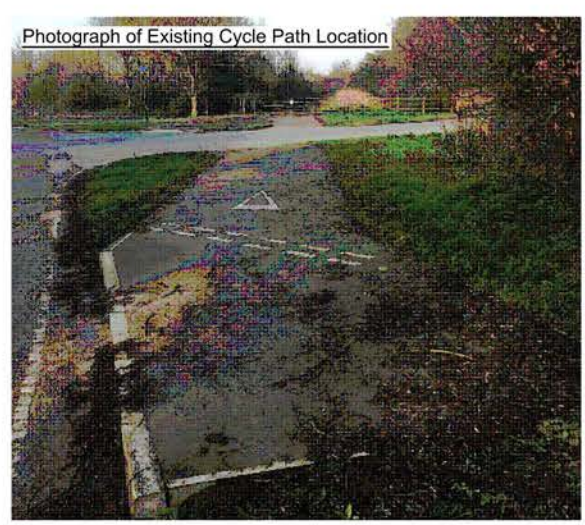
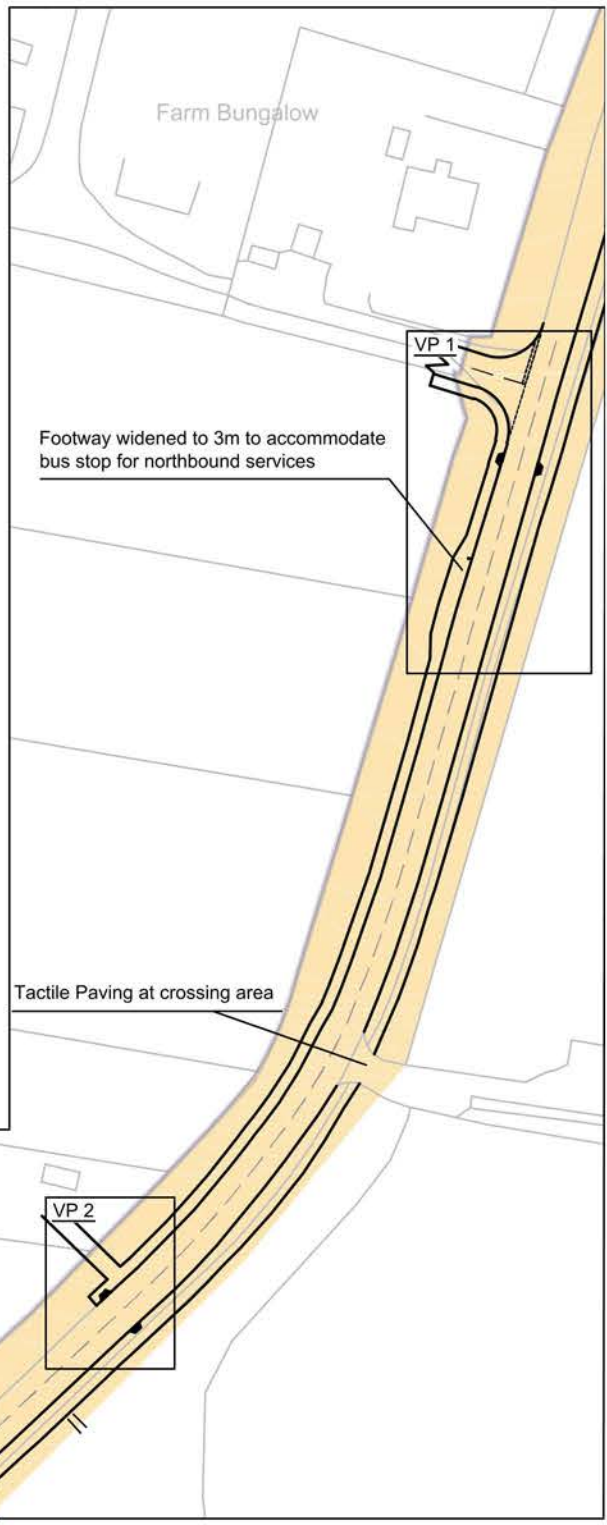

| | | | | | | |
|---------------|--|-------|-------|--|------|------------|
| Client | Gladman Developments | | | FLITCROFT HOUSE, 114-116 CHARING CROSS ROAD LONDON WC2H 0JR | | |
| T. | +44(0)20 3640 8508 | | | | | |
| W. | mail@iceniprojects.com | | | | | |
| Project | Bluntisham Road, Needingworth | | | | | |
| Job Ref. | 17-T046 | Drawn | FA | | | |
| Drawing Title | Proposed Footway Widening (3m Widening Southward) | | Scale | As Shown | Date | 05/12.2017 |
| Drawing no. | 12 | Rev. | C | | | |

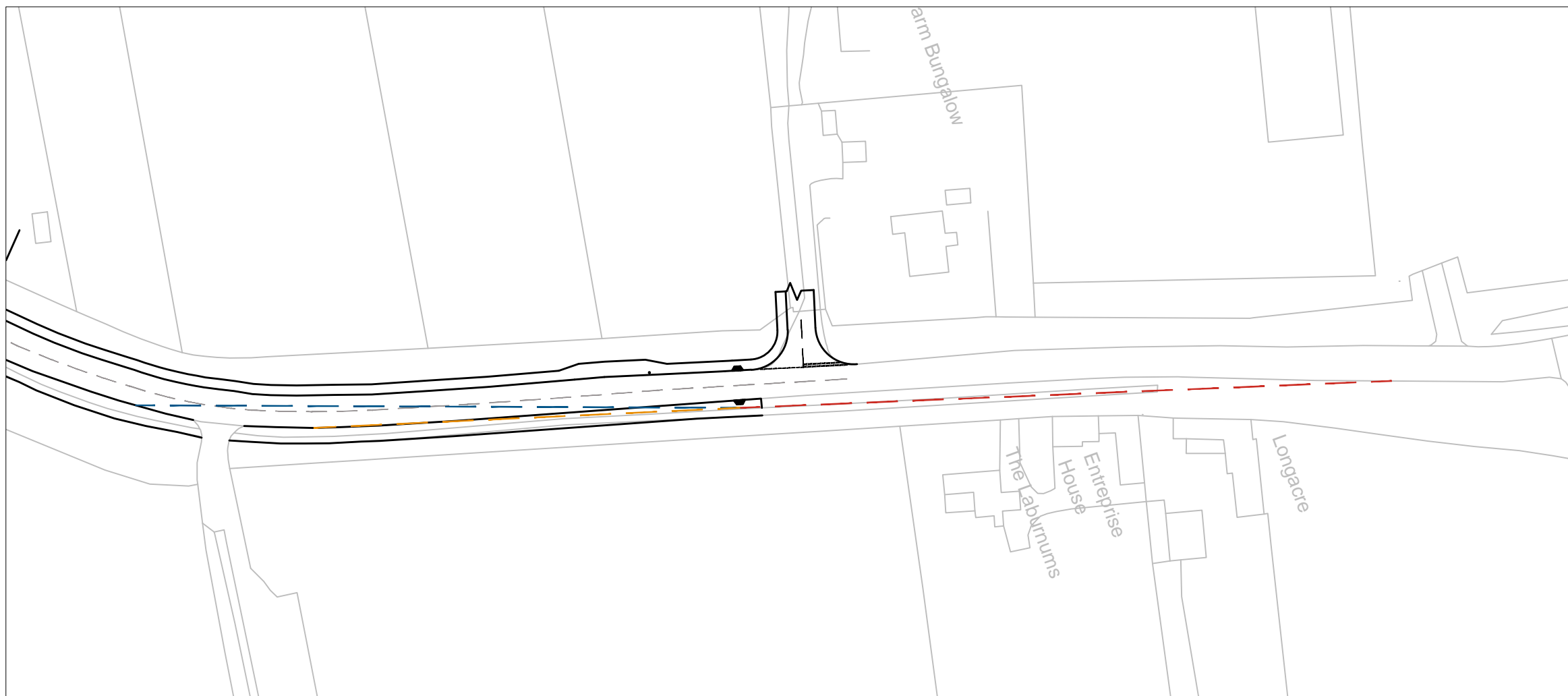

Notes;
 1.This drawing is based upon drawing number DWG No 101 supplied by Gladman Developments and Icen Projects Ltd. shall not be liable for any inaccuracies or deficiencies.
 2.This drawing is indicative and subject to discussions with local & national highway authorities. This design is also subject to confirmation of land ownership, topography, location of statutory services, traffic flows and traffic modelling.
 Key;

DMRB Calculated Visibility Splay of 1.5m x 128m* looking North
 (Based on 85th %ile Speeds of 41.9mph recorded in vicinity of Access 1**)

DMRB Calculated Visibility Splay of 1.5m x 119.5m* looking South
 (Based on 85th %ile Speeds of 39.4mph recorded in vicinity of Access 1**)

Visibility Splay to Tangential Points

Note:
 * Distance inclusive of bonnet length (2.4m)
 **Speeds have been adjusted to include wet weather reduction of 2.5mph
 X distance in accordance with DMRB TA 90/05

| | | | | | |
|----------|------------|--------------------|-------|-----|-----|
| A | 05.12.2017 | Revised Visibility | FA | NM | EF |
| Rev | Date | Amendments | Drawn | Chk | App |

Iceni Projects
 Flitcroft House
 114-116 Charing Cross Road
 London, WC2H 0JR
 T 020 3640 8508
 F 020 3435 4228
 mail@iceniprojects.com



Client
 Gladman Developments

Project
 Bluntisham Road, Needingworth

Title
 Visibility Splay
 Pedestrian Visibility Splays

| | | |
|----------------|--------------------------------|---------------------------------|
| Drawn By FA | Checked By NM 13/11/2017 | Approved By FP 13/11/2017 |
|----------------|--------------------------------|---------------------------------|



| | |
|----------------------|--------------------|
| Scale @ A3 1:1000 | Date 13/11/2017 |
|----------------------|--------------------|

| | | |
|------------------------|---------------------|-----------|
| Project No. 17-T046 | Drawing No. 12.1 | Rev. A |
|------------------------|---------------------|-----------|

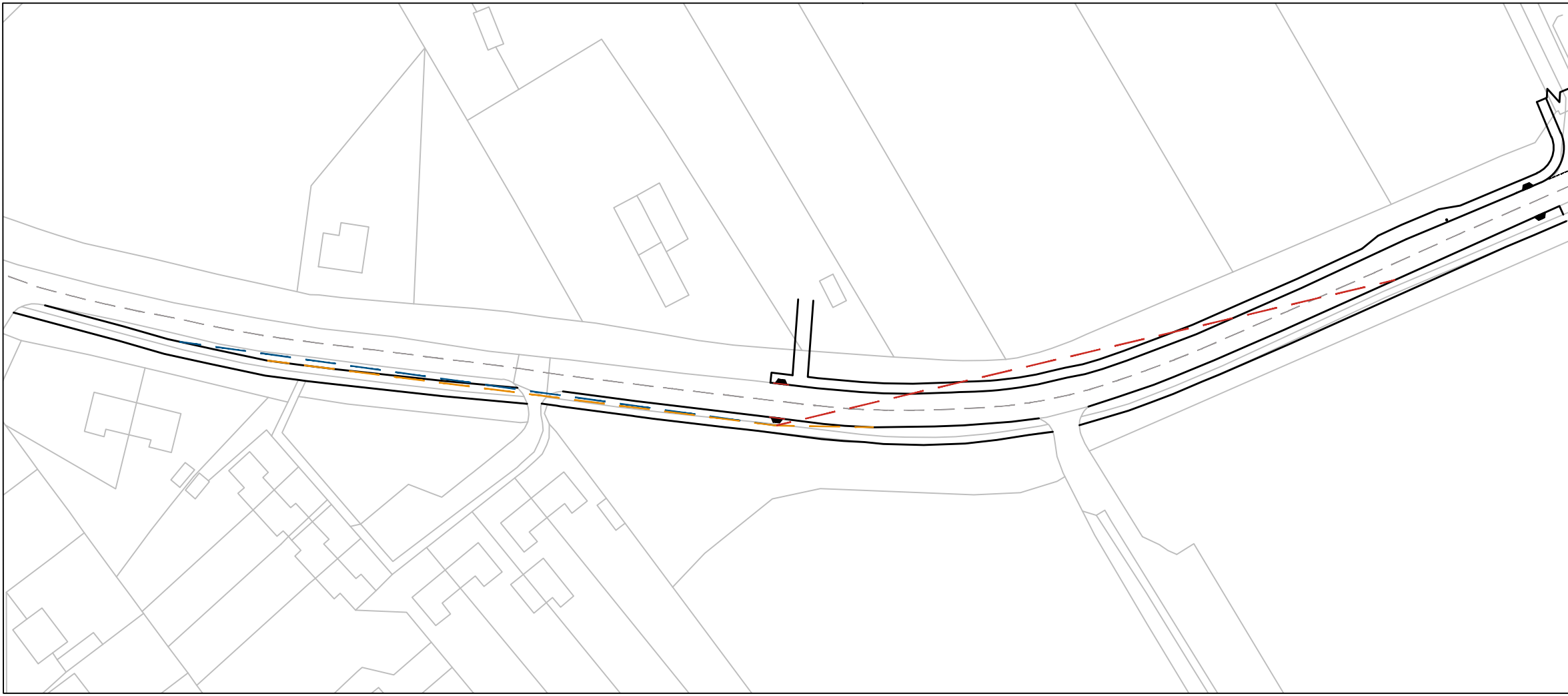
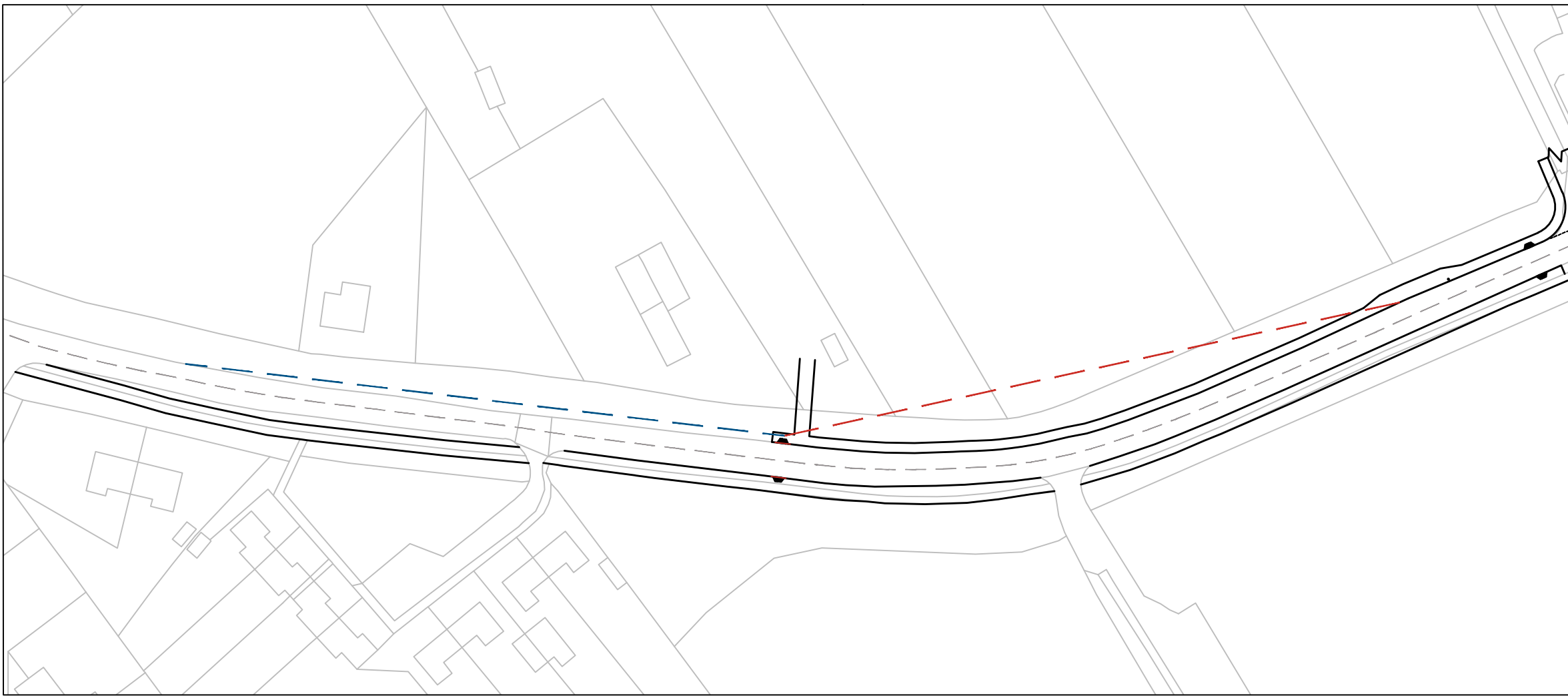
Iceni Projects accept no responsibility for any unauthorised amendments to this drawing. Only figured dimensions are to be worked to.



Notes;
 1.This drawing is based upon drawing number DWG No 101 supplied by Gladman Developments and Icen Projects Ltd. shall not be liable for any inaccuracies or deficiencies.
 2.This drawing is indicative and subject to discussions with local & national highway authorities. This design is also subject to confirmation of land ownership, topography, location of statutory services, traffic flows and traffic modelling.

Key;
 DMRB Calculated Visibility Splay of 1.5m x 128m* looking North (Based on 85th %ile Speeds of 41.9mph recorded in vicinity of Access 1**)
 DMRB Calculated Visibility Splay of 1.5m x 119.5m* looking South (Based on 85th %ile Speeds of 39.4mph recorded in vicinity of Access 1**)
 Visibility Splay to Tangential Points

Note:
 * Distance inclusive of bonnet length (2.4m)
 **Speeds have been adjusted to include wet weather reduction of 2.5mph
 X distance in accordance with DMRB TA 90/05

| Rev | Date | Amendments | Drawn | Chk | App |
|-----|----------|--------------------|-------|-----|-----|
| A | 05.12.17 | Revised Visibility | FA | NM | EF |

Iceni Projects
 Flitcroft House
 114-116 Charing Cross Road
 London, WC2H 0JR
 T 020 3640 8508
 F 020 3435 4228
 mail@iceniprojects.com



Client
 Gladman Developments

Project
 Bluntisham Road, Needingworth

Title
 Visibility Splay
 Pedestrian Visibility Splay

| | | |
|----------------|--------------------------------|---------------------------------|
| Drawn By FA | Checked By NM 13/11/2017 | Approved By FP 13/11/2017 |
|----------------|--------------------------------|---------------------------------|

| | |
|----------------------|--------------------|
| Scale @ A3 1:1000 | Date 13/11/2017 |
|----------------------|--------------------|

| | | |
|------------------------|---------------------|-----------|
| Project No. 17-T046 | Drawing No. 12.2 | Rev. A |
|------------------------|---------------------|-----------|

Iceni Projects accept no responsibility for any unauthorised amendments to this drawing. Only figured dimensions are to be worked to.

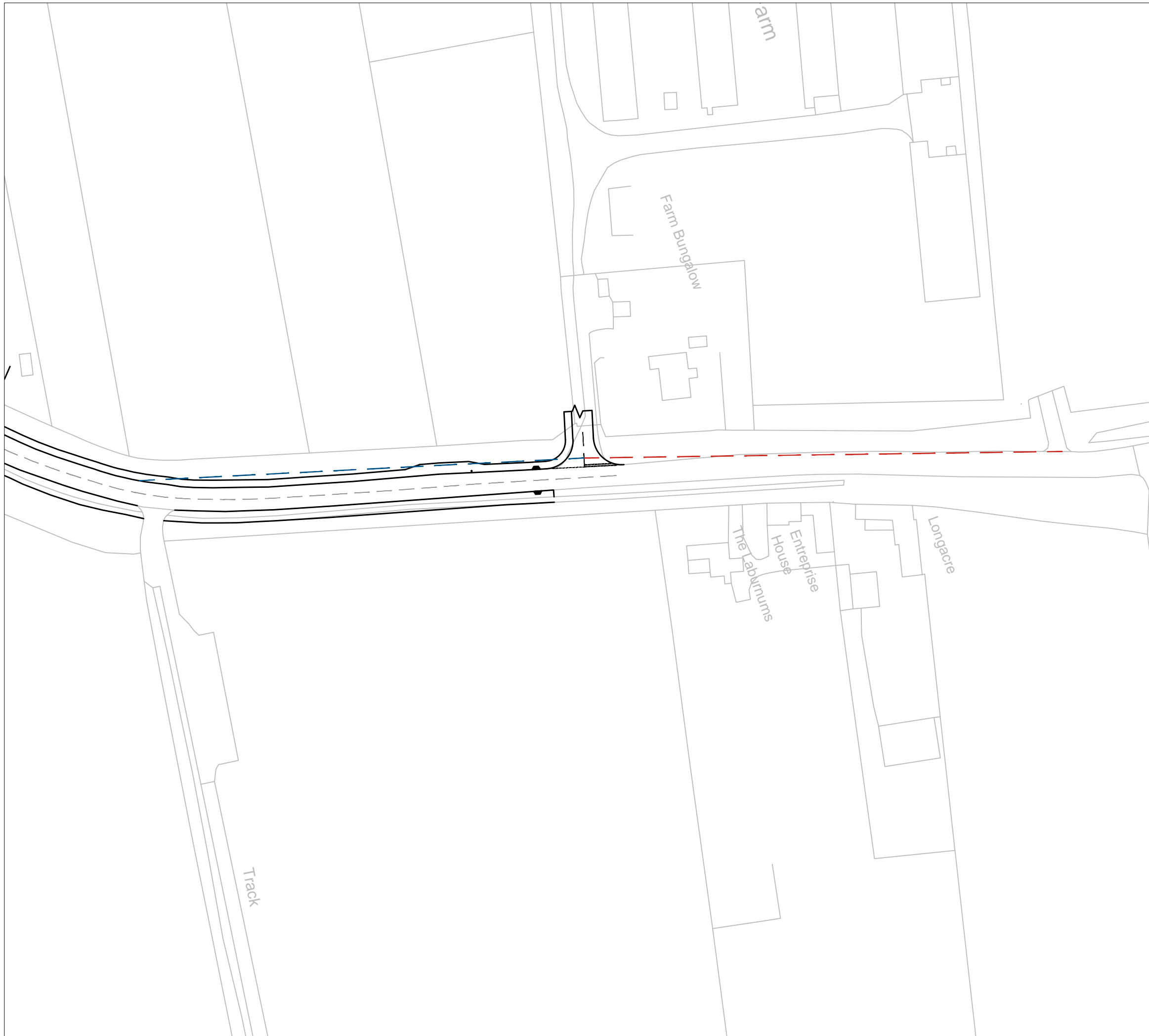

Notes;

- 1.This drawing is based upon drawing number DWG No 101 supplied by Gladman Developments and Icen Projects Ltd. shall not be liable for any inaccuracies or deficiencies.
- 2.This drawing is indicative and subject to discussions with local & national highway authorities. This design is also subject to confirmation of land ownership, topography, location of statutory services, traffic flows and traffic modelling.

Key;

DMRB Calculated Visibility Splay of 2.4m x 128m* looking North
(Based on 85th %ile Speeds of 41.9mph recorded in vicinity of Access 1**)

DMRB Calculated Visibility Splay of 2.4m x 119.5m* looking South
(Based on 85th %ile Speeds of 39.4mph recorded in vicinity of Access 1**)

Visibility Splay to Tangential Points

Note:
* Distance inclusive of bonnet length (2.4m)

**Speeds have been adjusted to include wet weather reduction of 2.5mph

| Rev | Date | Amendments | Drawn | Chk | App |
|-----|----------|--------------------|-------|-----|-----|
| A | 05.12.17 | Revised Visibility | FA | NM | EF |

Iceni Projects
Flitcroft House
114-116 Charing Cross Road
London, WC2H 0JR

T 020 3640 8508
F 020 3435 4228
mail@iceniprojects.com



Client _____

Gladman Developments

Project _____

Bluntisham Road, Needingworth

Title _____

Visibility Splay

Vehicle Visibility Splays

| | | |
|----------------|--------------------------------|---------------------------------|
| Drawn By FA | Checked By NM 13/11/2017 | Approved By FP 13/11/2017 |
|----------------|--------------------------------|---------------------------------|

| | |
|----------------------|--------------------|
| Scale @ A3 1:1000 | Date 13/11/2017 |
|----------------------|--------------------|

| | | |
|------------------------|---------------------|-----------|
| Project No. 17-T046 | Drawing No. 12.3 | Rev. A |
|------------------------|---------------------|-----------|